

## Levi W. Sutton (1807-1860); Bigamist?

© 1993 Raymond J. Porter. All rights reserved.

The ancestry of Levi W. Sutton remains undiscovered; he does not appear in any known compiled genealogy, and no record has been found of his birth, childhood, or siblings.

In an era when few men identified themselves with middle names or initials, Levi used his middle initial on marriage records in Kentucky and Ohio, and on his first census listing in Kentucky. No other record of a person using this name has been found in extensive research. The discovery of his name in the 1830 census in Kentucky was the key to further research that led to the conclusion that the Levi W. Sutton of Kentucky was probably the same man as the Levi W. Sutton of Ohio.

There is no doubt that the Levi W. Sutton who married Catharine Warren in Cuyahoga County, Ohio is the same Levi Sutton, the present writer's great-grandfather, who died in Allen, Michigan: this is amply documented. The connection to Levi W. Sutton of Kentucky is not as clear cut. However, the uniqueness of the name, the agreement of ages, and his disappearance from Kentucky before reappearing in Ohio leave little doubt in the writer's mind that they were one and the same man.

Unfortunately, his marriage to the writer's great-grandmother may have been without benefit of a divorce from his wife still living in Kentucky.

The evidence for this thesis is presented herein. All references in this paper to U.S. Censuses are from National Archives Microfilm.

### Levi's Origins

Levi was born about 1807, probably in New Jersey, possibly in Newark. The year of his birth is calculated from his age at death (52) in January 1860. His place of birth is given as New Jersey in his death record,<sup>1</sup> and is given as Newark, New Jersey in the death record of Mary L. "May" Sutton, his youngest daughter.<sup>2</sup>

The information in death records is frequently inaccurate, because the informant may not know the facts, particularly about the parents of the deceased. However, these records are the only ones discovered to date that have any information on his birth. No record of Levi's birth in Newark has been found, and no record of his death or burial has been found in Allen, Michigan.

The 1830 U.S. Census, the first in which Levi was old enough to be listed as a head of household, places him in Lewis County, Kentucky at that time. Lewis County was created from Mason County in 1807. There was a Benjamin Sutton on the Mason County tax list in 1800, but efforts to connect Levi to this family have been unsuccessful.

1

See 1980 Hudson Co, NY  
Census

JENNIE LOCKNER b. Aug 1854,  
30 45, wh, m. 27, 6 ch, 4 living,  
Ch William sep 1876 23 S <sup>Dead</sup>  
Anne M. Jun 1880 19 S <sup>Barber</sup>  
Grace D Mar 1883 16 S <sup>At school</sup>  
Olive R Dec 1887 12 S "

Anne M. also listed w/ George  
Hall family 23 HAS LOCKNER  
& Jun 1880 19 S Domestic Barber

## Levi W. Sutton in Kentucky

### KENTUCKY MARRIAGES

While there is no record of when Levi arrived in Lewis County, the first known record of his being there is a marriage license issued 2 January 1830 to Levi W. Sutton and Mary Moore. Joel Stratton was named as security. The proof of the parties age, etc. reads, "Both Parties are over the age of 21 years and a certificate filed." They were married 7 January 1830 in Lewis County by Henry Halbert, Justice of the Peace.<sup>3</sup>

This marriage did not last long, for on 16 July 1831 another marriage license was issued in Lewis County to Levi W. Sutton and Eleanor Moore. Joseph Moore is named as security. The proof of the parties age, etc. reads, "Levi W. Sutton over the age of 21 years & Personal Consent of Joseph Moore, father of Eleanor given." William F. Mavity wrote, "This Testifies that according to the Rites of the Sect to which I belong I joined in holy Wedlock Levi W. Sutton and Eleanor Moore July 18th 1831."<sup>4</sup> The form of the endorsement may or may not be a clue to their religious affiliation, but no significance has been found yet.

Mary Moore probably died as a result of the birth of their first child. There are no birth records of any of Levi's children, but census records and the marriage record of Robert J. Sutton in 1850 indicate that the child survived. Robert's age was 20 years in 1850, making him the son of Mary, not Eleanor. This would account for a hasty marriage to a younger sister (or another relative) to provide a mother to care for Robert. It seems likely that Joseph Moore was the father of both girls.

### DEEDS AND COURT RECORDS

On 4 September 1830 Levi W. Sutton purchased, for \$30.00, Lot No. 42(?) from the trustees of the newly formed Town of Concord.<sup>5</sup> He sold the lot, for (illegible), to William Wade a few months later, on 10 May 1831.<sup>6</sup>

Levi's relationship with William Wade is unknown, but he brought suit in Chancery Court against William Wade and Mary Hamlin, administratrix of the estate of William Hamlin, deceased. The date and nature of the suit have not been determined, because the court records have been destroyed by flood. It appears from court orders that Levi asked for some kind of injunction against the defendants.

In the first court appearance, 21 October 1839, Mary Hamlin was living out of state and failed to appear. The case was continued until the next term of the court, at which, in June 1840, Mary Hamlin failed to appear again, and the case was continued again to the next term. Both defendants failing to appear at this term, in September 1840, the injunction obtained by Levi was made perpetual.<sup>7</sup>

Since Mary Hamlin was named as executrix of William Hamlin's estate, there might be some family connection between the Hamlins and the Suttons or Moores. This avenue has not been explored yet. No other court records are listed for Levi Sutton in the General Cross Index for Lewis County for the years of 1807-1953.<sup>8</sup>

**CENSUS RECORDS**

Levi is listed in the 1830 and 1840 U.S. censuses for Lewis County:

**1830 Census: Lewis County, Kentucky<sup>9</sup>**

Head of Family	Males	Females
Levi W. Sutton	2 20-30	1 20-30
	1 5-10	1 15-20

One of the males in the 20-30 age group is Levi, and the female in the same age group is Mary. There is no evidence as to who the other three persons in his household were; the child is too old to be his.<sup>10</sup>

**1840 Census: Lewis County, Kentucky<sup>11</sup>**

Head of Family	Males	Females
Levi Sutton	1 30-40	1 20-30
	1 10-15	1 5-10
		3 0-5

Three of those listed can be identified as Levi, Eleanor, and Robert (age 10). The names of their four daughters have not been discovered.

Levi does not appear anywhere in the 1850 U.S. Census, nor does Eleanor, but their son, Robert J. Sutton, is listed in Lewis County:

**1850 Census: Lewis County Kentucky, District 1<sup>12</sup>**

Fam. No.	Name	Age	Sex	Occupation	Value of Real Estate	Birth-place
513	Robert J. Sutton	20	M	(none)	(none)	Ken.
	Elizabeth	22	F			Ohio

Robert married 7 May 1850 in Lewis County, Elizabeth Featherkile. Their marriage record contains the notation, "A certificate from Eleanor Sutton Mother of Robert J. Sutton giving her consent as proved by the oath of Daniel Hildebrand & Elizabeth Featherkile is over the age of 21 years as proved by the oath of Hildebrand."<sup>13</sup> The fact that Eleanor gave permission for the marriage, not Levi, supports the thesis that Levi left the family before that date.

Robert and Eleanor Sutton both appear in the 1860 U.S. Census for Lewis County:

1860 Census: Lewis County, Kentucky<sup>14</sup>

Fam. No.	Name	Age	Sex	Occupation	Value Real/Personal	Birth-place
368	Robert J. Sutton	30	M	Farmer	—./ 50	Ken.
	Elizabeth	32	F			"
	John H.	7	M			"
	Nancy E.	4	F			"
	George H.	6/12	M			"
481	Eleanor Sutton	47	F			"
	Joshua	10	M			"

The Census microfilm varies in legibility from barely legible to totally illegible.. One of Robert's sons is named George H.. There was a George Sutton in Lewis County, who married, 12 October 1840, Julia Ann Shepherd.<sup>15</sup> No connection of this George to Levi's family has been found, but it is possible that Robert's son, George, was named after him.

Eleanor Sutton is listed with one male child, Joshua, age 10. It is unlikely that this is her child, because Levi left the family several years before Joshua was born. It seems more likely that Joshua is Robert's son staying with his grandmother.

**TAX RECORDS**

Levi appeared on the Lewis County tax rolls for the first time in 1830.<sup>16</sup> Only persons over 21 years of age were listed. From his age at death (52) in January 1860, he was probably 21 sometime in 1828. This may imply that he came to Lewis County in 1829 or 30, or he may have been omitted in 1828 and 1829 because he was not a head of household.

Levi appeared in the 1830–1844 Lewis County tax rolls (the listing for 1832 is missing on the microfilm). He does not appear thereafter. During this entire period, he had virtually no estate other than a horse and, later, a cow or two. When they started listing school-age children in 1840, Levi had two aged 7 to 17 years. This is consistent with his listing in the 1840 U.S. Census. In 1841, two children aged 7 to 17 were listed; in 1842, none were listed; in 1843, four between the ages of 5 and 16; in 1844, three between the ages of 5 and 16.

No Suttons (other than a George Sutton in the Cabin Creek area) appear in the 1845–1847 tax rolls. Ellen (Eleanor) reappears in 1848 with no males over 21 years and three children between the ages of 5 and 16. She does not appear again until 1853, when she was listed as "Nelly," with three children between the ages of 6 and 18. In 1856 she is listed with two children in the same age group. Her last listing on the 1844–1859 microfilm is in 1857, when she had one child in the school-age group. She

may be the blind person who was listed with Robert Sutton in 1859. Further research on later tax lists is ongoing to reconstruct the lives of this family.

Robert Sutton showed up, as expected, in the 1851 tax roll after his marriage in 1850, is missing in 1852, then shows up in 1853–59, the last year checked. A Jackson Sutton also showed up in 1851 and 1853. He would have to have been born in or before 1830 to be over the age of 21 in 1851. He cannot be one of Levi's children.

These tax records are clear evidence that Levi resided in Lewis County from 1830 to 1844, that he died or left the county before June 1845, and that his family remained there at least until 1859.

#### SUMMARY

We can only speculate why and how Levi left his family. There is no evidence that he died there. In Kentucky, divorces were obtained by an Act of the Legislature up to 1848 and are recorded in the Acts. There is no divorce listed for Levi Sutton in the index of divorces taken from the Acts, nor are there any court records listed for Levi Sutton in the General Cross Index for Lewis County for the years of 1807–1953 other than those mentioned above. The fact that a man of the same peculiar name and the same approximate age showed up in Cuyahoga County, Ohio a couple of years later marrying Catharine Warren strongly suggests that Levi and Eleanor separated or that he abandoned her and his family. While he swore on his marriage license application that he had no wife living, unless a divorce record can be found, that marriage was bigamous.

#### Levi W. Sutton in Ohio

No trace has been found of Levi W. Sutton from the time of his disappearance from the records of Kentucky until he applied for a marriage license in Cuyahoga County, Ohio on 25 June 1847 to marry Catharine Warren, daughter of Daniel Warren.<sup>17</sup> He was about 42 years old, and she was 17. Being under the age of 18, the word *eighteen* was crossed out in the phrase "that she is of the age of eighteen years" on the preprinted application, and *sixteen* was written in above it. The following was written in on the application: "I consent to the above being the father of the said Catharine. June 25, 1847 (Signed) Daniel Warren." Apparently 16 was the youngest that he could have given permission; it was not her age. Levi swore that he was of the age of twenty-one years (*i.e.*, over the age of twenty-one) and that he had no wife living. The veracity of the latter statement remains to be proved, but is in serious doubt.

They were married 30 June 1847 in Dover Township (now known as Westlake) in Cuyahoga County by Austin Seeley, Justice of the Peace.<sup>18</sup> No farther trace of them has been found until they showed up on the 1860 census in Allen, Michigan.

No information has been found on the ancestry of Catharine despite extensive research. The name of her mother is unknown. According to her death certificate and her obituary, she was born 30 November 1829 in Akron, Ohio.<sup>19</sup> The information for both was supplied by her daughter, May, who didn't know her grandmother's name. It could well be erroneous unless confirmation can be found.

**Levi Sutton Family in Michigan**

Porter family records show that "May" Sutton, Levi's youngest daughter was born 11 January 1859 in Allen, Michigan.<sup>20</sup> No birth or death records were being kept in Michigan at that time, so it is fortunate that Levi's family was listed in the 1860 census; he in the Mortality Schedule,<sup>21</sup> and his survivors in the Population Schedule. No other records exist of his death or ~~burial~~, or of the births of his daughters.

*Levi is buried in lot 30 in the South Allen Cemetery. There is no grave marker, the lot was purchased 13 Aug 1925 by his daughters, Jennie Fox and Mary Linton (Cem Rec at Hillsdale County, Michigan, Vol II, p 50)*

1860 Census: Allen, Hillsdale County, Michigan<sup>22</sup>

Fam. No.	Name	Age	Sex	Occupation	Value Real/Personal	Birth-place
	Catharine Sutton	30	F	Wid.	—150	Ohio
	Lydia	8	F			Mich.
	Sarah	5	F			Mich.
	Mary	1	F			Mich.
	Mary Warren <sup>Warren</sup>	60	F			Unk.

The death certificate of Mary "May" (Sutton) Linton provides the link that proves that the Levi Sutton listed in the mortality schedule is the same Levi Sutton that married Catharine Warren in Ohio.<sup>23</sup> In it her parents are identified as Levi Sutton and Catharine Warren. Further proof is provided by the death certificate of Catharine Warren, on which the informant was Mrs. May L. Linton.<sup>24</sup> Catharine's parents are identified as Daniel Waring [*sic*] and Don't Know. (*Linton* was May's last husband's name.)

After Levi's death, Catharine remarried on 7 November 1861 in Hillsdale County, Eli Banker, age 42, by G. W. Warren, Justice of the Peace.<sup>25</sup> Witnesses were Lydia Fox and Matilda Fox. Eli was a widower, who served in the Michigan Provost Guards 1862-1865.

It is interesting to speculate about the significance of the names of the J.P. and the witnesses. Catharine's maiden name was Warren, the J.P. was G.W. Warren, and her daughter, May, first married a George Warren. The witnesses were Lydia and Matilda Fox, and Catharine's daughter, Sarah, married second a Fox. While these similarities may be just coincidence, further research could turn up family connections.

It is not known whether Eli died before Catharine, or they were divorced. She was apparently using the name *Sutton* when she died. She was buried in Hudson, Michigan 21 February 1910. Her obituary read:

**Mrs. Katherine Sutton**

Mrs. Katherine Sutton was born in Akron, Ohio, Nov. 30, 1839. died aged 80 years at the home of her daughter, Mrs. Jennie Fox, better known as Mrs. Lockmer, of Liberty Center, Ohio.

She made her home in Hudson, Mich. for many years. Besides her two daughters, Mrs. Jennie Fox, of Liberty Center, O., and Mrs. Mae Linton of Medaryville, Ind., she leaves a number of grandchildren, great-grandchildren and a host of friends to mourn their loss.

The remains were brought to Hudson for burial Feb. 21, 1910.

**Genealogical Summary**

1. Levi W.<sup>1</sup> Sutton was born about 1807, probably in New Jersey, possibly in Newark. and died January 1860 in Allen, Michigan, aged 52 years. His parentage remains unknown. He was apparently a common laborer and never accumulated any wealth or property. He married first 7 January 1830, in Lewis County, Kentucky, Mary Moore, probably the daughter of Joseph Moore. She probably died before 16 July 1831. Levi married second 18 July 1831, in Lewis County, Eleanor Moore, daughter of Joseph Moore. Her age in the 1860 U.S. Census was forty-seven. The date of her death is unknown. No record has been found of a divorce of Levi and Eleanor in Kentucky.

Levi married third 30 June 1847, in Dover Township (now known as Westlake), Cuyahoga County, Ohio Catharine Warren, who was born 30 November 1829, possibly in Akron, Ohio and died 18 February 1910 in Liberty Center, Ohio. She was the daughter of Daniel Warren, who signed her application for a marriage license 25 June 1847 giving his consent to the marriage of his underage daughter. After Levi's death, she married second, 7 November 1861, in Hillsdale Township, Hillsdale County, Michigan, Eli Banker, a widower, who served in the Michigan Provost Guard 1862-1865. The date of his death is unknown. There were no known children born to this marriage..

The only child of Levi W. Sutton and his first wife, Mary Moore, was:

- 2 i. Robert J.<sup>2</sup> Sutton, b. at Concord 1830; m. Elizabeth Featherkile at Lewis County 7 May 1850. Children listed in 1860 U.S. Census: John H, age 7; Nancy E., age 4; George H., age 6/12. Robert's occupation was listed as farmer. Another child; Joshus, age 10: was listed with Robert's step-mother and is probably his.

There were apparently four children born to Levi .W. Sutton and his second wife, Eleanor Moore. Research on these children is ongoing. It appears, with some degree of certainty, that one was Mary E. Sutton, who married John H. Bayless. There was also an Ann Sutton, who married Bonei? Virgin. There is presently nothing to tie her to Levi. The names of the other two are unknown.

The known children Levi W. Sutton and his third wife, Catharine Warren, were:

- 7 i. Lydia Ann<sup>2</sup> Sutton, b. ca. 1852; probably in Allen or Coldwater, Michigan; m. (1) 1 January 1870 in Coldwater, Michigan, Ezeriah J. Parmelee, age 38, of Hudson, Michigan. He was a carpenter and was born in Volney, Oswego County, New York.<sup>26</sup> He served in the Civil War.
- 8 ii Sarah Jenny Sutton, b. ca. 1855, probably at Allen or Coldwater, Michigan; m. (1) Willard Lockmere; m. (2) \_\_\_\_\_ Fox.
- 9 iii Mary L. "May" Sutton, b. 11 January 1859 in Allen, Michigan; d. 8 May 1928 in Toledo, Ohio;<sup>27</sup> m. (1) 28 October 1874 in Coldwater, Michigan, George Warren, age 19, of Union City, Michigan.<sup>28</sup> George was born in Jonesville, Michigan and was a farmer. It is not known what happened to him, whether or not there was a divorce, and whether any children were born to this marriage.

May m. (2) ca. 1878, Clarence James Porter, Sr., the son of Van Rensselaer Porter and Eliza Rogers of Sandy Creek, New York. No record of this marriage has been found. Clarence was a salesman and may have been married twice before marrying May. By 1880, he was calling himself "Doctor" and was peddling spectacles. They were divorced 31 March 1903 in DeKalb County, Indiana.<sup>29</sup> He d. 27 October 1917, Chicago, Ill.<sup>30</sup> Their children were: (a) Pearl Esther Porter, b. 11 July 1879, Hudson, Michigan;<sup>31</sup> d. 24 March 1942, Chicago, Illinois; m. 13 August 1899, Waterloo, Indiana, Dwight William Smith;<sup>32</sup> (b) Louis Earl Porter, b. 16 February 1882, Hudson, Michigan;<sup>33</sup> d. 21 March 1953, Toledo, Ohio; m. 9 March 1918, Waterloo(?), Indiana, Martha Boucher;<sup>34</sup> (c) Jenny Catharine Porter, b. 7 January 1884, Orland, Indiana; d. 6 November 1958, Indianapolis, Indiana; m. 21 August 1904, Waterloo, Indiana, Howard L. Carver;<sup>35</sup> (d) Maude Ivy Porter, b. 14 July 1887, Orland, Indiana; d. 14 January 1965; m. Dane Newlin; (e) Clarence James Porter, Jr., b. 13 April 1890, Waterloo, Indiana;<sup>36</sup> d. 17 October 1977, Long Beach, California;<sup>37</sup> m. (1) 6 November 1916, Hattie Pearl Clark: divorced 2 November 1922, Chicago, Illinois;<sup>38</sup> m. (2) 9 July 1924 Chicago, Illinois, Mary Ellen "Marie" Irwin;<sup>39</sup> (f) Van Rensselaer Porter, b. 3 April 1894, Waterloo, Indiana;<sup>40</sup> m. 11 July 1914, Reading, Michigan, Lillian F. Northrup; divorced 27 October 1921;<sup>41</sup> m. (2) Florence \_\_\_\_\_;<sup>42</sup>

May m. (3) 4 March 1909 in Crown Point Indiana, Samuel Linton of Medaryville, Indiana, an undertaker. Nothing further is known about this marriage or about Samuel Linton.

## Epilogue

The above article makes a pretty good circumstantial case for the thesis that Levi W. Sutton of Kentucky and Levi W. Sutton of Ohio are the same man. It was originally written for submission to *Sutton Searchers* in the hope that one of their readers might be descended from Levi in the Kentucky line and be able to provide more information on him and his ancestry. The Genealogical Summary was extended to include Clarence and May's children only, because there are several descendants of Clarence Porter still living, who are interested in the family history and who might have information to add to what I have found so far about them. Some of the questions about Levi in Kentucky that occur to me are:

- Who were Levi's parents, and where was he born?



- What happened to Mary Moore? Did she really die in childbirth? Who were her parents, and where was she born?
- Who were the parents of Eleanor Moore, and where was she born?
- Is the form of the marriage endorsement on Levi and Eleanor's marriage record significant? Were they Quakers? If so, there is a rich source of records available.
- Who were William Wade and Mary Hamlin? What was their connection to the Sutton/Moore family?
- Was Levi's first son, Robert J. named after Levi's father? What did the *J* stand for? Who was Jackson Sutton?
- What were the names and birth dates of Levi and Eleanor's children? Whom did they marry?
- Who was George Sutton, who lived in the Cabin Creek area?
- Who was Thomas Sutton, who was listed in the 1840 census?
- Was Ann Sutton, age 13, who was living with the James Henderson family in the 1850 Lewis County census, one of Levi's daughters?
- Who was Nancy Sutton, age 48, who was living with three children in the 1850 Lewis County census?
- When and why did Levi leave his family? Were they divorced?
- What happened to Eleanor? Her death records could contain interesting information.

After he arrived in Ohio, assuming that the two Levi's were, indeed, the same man, there is no question about him being the father of May Sutton, who married Clarence Porter, Sr. The descent is adequately documented to the point of certainty. However, many questions remain to be answered about Catharine Warren and their descendants: Some of the questions below go beyond what was presented in the article, since the purpose of the article was only to link Levi of Kentucky and Levi of Ohio. Efforts to gather information on their descendants go far beyond what is presented here, and are ongoing.

- Where did Levi go and what did he do after he left his family? Where did he meet Catharine?
- Who were Catharine's parents? Was she really born 20 November 1929 in Akron, Ohio as stated on her death certificate and obituary? The information for both was supplied by her daughter, May, who didn't know her grandmother's name. If so, what was her family doing there? Canal workers?
- Was Daniel Warren the same man as Daniel Warren of Warrensville, Ohio? Was he a relative of that Daniel in another line? There were many Daniels in that family.
- Was May L. Sutton's middle name Lovisa, as appears possible/probable? If so, that could strongly suggest a connection with the Warren family with many Daniels, There were also several Lovisas in the family.

- How did Levi meet Catharine and how did he, a 42-year-old man, marry a 17-year-old girl with her father's permission? Unless a child died, she was not pregnant when they married..
- Where did they live between 1847 and 1860? What did Levi do for a living?
- How did Levi's family get to Allen, Michigan? Did they move with other families?
- Were there any children other than those in the 1860 census?
- Was the Mary Sutton, age 60, living with Catharine in 1860 her mother? What happened to her?
- What is Eli Banker's story? What did he do after the Civil War? Where and when did he die?
- Did Catharine and Eli Banker have any children? Was the child that died during the war theirs or one of his from a previous marriage?
- Was there any relationship between the G.W. Warren that married Catharine and Eli, Catherine's family, and the family of George Warren, who May married?
- Was there any relationship between the Foxes that witnessed Catharine and Eli's marriage and the Fox that Sarah, her daughter, later married?
- What happened to Ezeriah Parmelee? Did Lydia remarry? What happened to her? Any descendants from Ezeriah or a subsequent husband? Where did they live? When and where did she die? She apparently predeceased her mother; she is not mentioned in Catharine's obituary.
- What happened to Sarah's marriage to William Lockmere? When and where were they married? Any descendants? Who was her second husband? Any descendants? Where did they live? When and where did she die?
- Was Sarah's middle name Jenny? If so, was it really Jenny, or was that a familiar form of Joan? Also, was Jenny Porter's real name Jenny or Joan?
- What happened to George Warren? Did he die before May's marriage to Clarence Porter? Were they divorced? Were there any children?
- When and where were May and Clarence married? Was Clarence married to Anna Gillette and/or Flora Westcott before marrying May? If so, was he still married to either when he married May?
- Who was Mae L. Kunev, who was the informant on May Linton's death certificate?
- Who was Louis Porter's second wife? Who were his descendants?
- When and where were Maude Porter and Dane Newlin married? Was his name really Dane or Daniel? His name was listed as Daniel in an early Chicago city directory.
- Was Clarence Porter, Jr. born in Orland or Waterloo?
- What happened to Van Porter's son, Howard Van? Who was his second wife? Any children?

## Notes and References

---

1. 1860 U.S. Census, Allen, Hillsdale County, Michigan; Mortality Schedule, page 1; Levi Sutton, age 52, married, born N. Jersey, died January, 1860 of inflammation of lungs, which he had for 18 days.
2. Death certificate of May L. Linton [née Sutton], 9 May 1928. State of Ohio, Department of Health, File No. 31951 gives her father's name as Levi Sutton and his place of birth as Newark, N.J. The informant was Mae L. Kuney, who lived at the same address as May. Her relationship is unknown.
3. Lewis County, Kentucky Marriage Book A:96, No. 634.
4. *Ibid.*, :105, No. 686.
5. Lewis County, Kentucky Deeds F:332.
6. *Ibid.*, F:(illegible).
7. Lewis County, Kentucky Court Records, Order Book G:262, 338, 369, Suit 2394.
8. Comment by Janie Games, Archive Staff, Public Records Division, Kentucky Department for Libraries and Archives, on reply form, dated 1 September 1990, in response for the present writer's request for a search for Levi Sutton's divorce records.
9. 1830 U.S. Census, Lewis County, Kentucky, p. 298.
10. There is a Thomas Sutton listed one page after Levi in the 1840 census. He and his wife are the right ages to be two of these, but she was probably too young to have a child of that age. If it is the same couple, the son did not survive until 1840. Thomas could be a relative of Levi.
11. 1840 U.S. Census, Lewis County, Kentucky, p. 622.
12. 1850 U.S. Census, Lewis County, Kentucky, p. 239
13. Lewis County, Kentucky Marriage Book C:54, No. 24.
14. 1860 U.S. Census, Lewis County, Kentucky, pp. 51, 66, 67.
15. Lewis County, Kentucky Marriage Book B:56, No. 34.
16. Lewis County, Kentucky tax records 1807–1843 (GS Film 0008110) and 1844–1859 (GS Film 0008111).
17. Cuyahoga County, Ohio Marriage Applications 1841–1851 (GS Film 0872467).
18. Cuyahoga County, Ohio Marriage Records 4:403 (GS Film 087913). Austin Seeley's commission in Dover Township is listed in Wm. Stephenson (comp.), *Smead & Cowles General Business Directory of the City of Cleveland for 1848–9* [Cleveland, 1848]
19. Death certificate of Cathren [sic] Sutton [née Warren], 18 February 1910. State of Ohio, Bureau of Vital Statistics, File No. 8921. The obituary is affixed to the back of a photograph of Catharine and is apparently from a Hudson, Michigan newspaper. The newspaper and date of publication are not recorded.
20. "Birthday Book" compiled by Clarence J. Porter, Jr., May's son.
21. See note 1 above.
22. 1860 U.S. Census, Hillsdale County, Michigan.
23. See note 2 above.
24. See note 19 above.
25. Hillsdale County, Michigan marriage records. Certified copy in the possession of the writer; no book or page no. shown.
26. Branch County, Michigan marriage records, No. 679. They were married by A.W. Curtis, M.G. Witnesses were Catharine Banker (her mother) and Marilla Clapp. Clarence Porter, who married her sister, was born in Sandy Creek, New York, near Volney, and his father was a carpenter. Another coincidence?

27. State of Ohio, Department of Health, Division of Vital Statistics death certificate, File No. 31951.
28. Branch County, Michigan marriage records, No. 1964. They were married by David B. Purington, J.P.; witnesses were Grace Warren and Alfred Thompson.
29. DeKalb County, Indiana court records, March Term, 1903, Case 6831. May divorced Clarence. The complaint filed by May, which could contain the date and place of their marriage, could not be found by the clerk.
30. State of Illinois death certificate, Registered No. 31975. His occupation at that time was paint salesman.
31. Lenawee County, Michigan birth records, No. 311. Clarence is listed as a farmer, born in Michigan. Both are errors.
32. DeKalb County, Indiana marriage records, 16:24.
33. Lenawee County, Michigan birth records. Birth confirmed in person by the writer with the Lenawee County Deputy Clerk, but no certified copy was purchased.
34. DeKalb County, Indiana marriage records, 26:149.
35. DeKalb County, Indiana marriage records, 17:42
36. Indiana State Board of Health, Division of Vital Records Birth Certificate, Volume D-1479, Certificate 58409. This was a delayed birth certificate, obtained by affidavit 25 February 1948.
37. State of California, Department of Health Certificate of Death.
38. Cook County, Illinois Superior Court Decree of Divorce No. 381639. Clarence divorced Hattie on the grounds of desertion.
39. Marriage certificate issued by Judge Harry W. McEwen in possession of the writer.
40. DeKalb County, Indiana birth records, H-2:27.
41. Marriage and divorce data are from Hillsdale County, Michigan divorce records, p. 43, No. 5143. Lillian divorced Van on grounds of extreme cruelty.
42. "Birthday Book" compiled by Clarence J. Porter, Jr., May's son.

Allen  
John  
6  
Allen  
John  
5  
Allen  
John  
4  
Allen  
George  
3  
Allen  
John  
2  
Allen  
John  
1

John  
1900  
1900

# South Allen Cemetery Allen, MI.

Allen Top Clerk

Allen

Rev 9-10-51

SOUTH ALLEN CEMETERY

Between Drives

Row 5 Numbering begins at north end of row.

30. Fox-Linton No stones. Note in Cemetery Record of Lots Sold, "Occupied by their father for years." Lot purchased by Jennie Fox and May Linton 8-13-1925.

31. Harlan

Hattie V.  
1893-1911

Cora B.  
1883-1953

Ray E.  
1887-1954

32. Bird

Romina, wife of  
Wright Redding  
d. 11-30-1861  
49 yr

Charlotte, wife  
of Erastus Bird  
d. 5-8-1860  
34 yr 10 m 20 d

Erastus Bird  
9-28-1821  
12-19-1890

Redding stone broken at family name. Information from Vivian Lyon Moore's County Deaths Before 1867. State Library.

33. Ranney

Achsah Sears  
wife of George  
Ranney  
4-11-1789  
8-7-1869

George  
5-12-1789  
9-9-1842  
War of 1812

Caroline E.  
dau of Lucius  
& Clarissa A.  
d. 2-2-1858  
7 yr 4 m 10 d

Lucius  
1819-1894

Clarissa A.  
1830-1893

Priscilla Densmore  
1822-1908

Lewis R. Ranney  
d. 2-5-1881  
65 yr 10 m 26 d

Priscilla Ranney Densmore's husband is buried at St. Ignace.

34. McConel

Frank  
dau of PH & Esther A.  
d. 5-27-1860  
2 yr 11 m 27 d

Augusta D. Thomas  
1-29-1848  
1 yr.

Our Mother  
Polly, wife of  
David Thomas  
5-5-1875  
72 yr. 11 d.

Augusta D. Thomas  
1-2-1848  
11 m. 3 d.

Our Father  
David Thomas  
9-16-1802  
10-7-1880

Augusta D. Thomas  
5-29-1850  
11 yr. 5 d.

10-1-1841  
4 yr. 2 m. 27 d.

26. Bradshaw

Ellis E. Bradshaw  
1890-1970

Beatrice Bradshaw  
1896-1962

27. Bradshaw

David F. Bradshaw  
1885-1936

28. Crandall

Mary Elizabeth, dau  
of Hosea & Mary  
d. 3-3-1861  
10 yr. 11 m. 17 d.

29. Webster

---

Row 5. Numbering begins at north end of row.

---

30. Fox-Linton

There are no markers on this lot which was purchased 8-13-1925 by Jennie Fox and Mary Linton. A note in the twp. record reads "Occupied by their father for years."

Free Love.

"Free Love" as an epithet of reproach has been freely bandied for years between those holding different views on the marriage relation, and with especial emphasis has been charged upon those holding religious views not in accord with the popular standard.

Arrayed on the one side are Horace Greeley, Hubert Colfax, Henry Ward Beecher, Theodore Tilton, etc., etc., supported by the New York Tribune and Independent, who sustain Richardson against the charges of the religious and secular press and the pulpit, of seduction and marriage in violation of civil and ecclesiastical law.

This charge of "Free Love" against persons holding so high position in church and state, for they are all Methodists and leading members of the party of "Great Moral Ideas" - the Republican party - has led to a very full discussion of the question of divorce and marriage.

With the legal question we do not now propose to meddle, but simply glance at the theological aspect as exhibited by two orthodox journals which take opposite views on the question.

Presbyterian Episcopal. - No minister is allowed to solemnize matrimony in any case where there is a divorced husband or wife of either party still living; but this is not to apply to the innocent party in a divorce for adultery, or to parties once divorced seeking to be united again.

Catholic Church. - Divorce, except as to bed and board, not recognized in any case; and no divorced party to be remarried while the other is living.

Baptist. - Divorce recognized for adultery only, the innocent party to be allowed to remarry. We understand this to be the position of the regular church, as it was of the recent branches. We think, if not all other, Presbyterian Churches adhere to the same rule.

Methodist. - Substantially the same as the Presbyterian.

Congregational. - This denomination having no common authority, except the Bible, each separate church determines such matters for itself under the advice and counsel of Associations; but we think there is little difference in practice in the rule of Presbyterian and Methodist churches being the case followed.

Baptist. - Like the Congregationalists, the Baptists have no ecclesiastical authority, each church determining all questions for itself. The practice, however, is substantially the same as that of the three preceding denominations, the Bible rule being the guide.

[From the Independent.]

This horrible case is a new illustration of the folly and wickedness of that unscriptural sentiment which, in the name of maintaining the sanctity of marriage, outrageously perverts the very idea of marriage, by compelling the life long union of two persons either of whom fade such a union to be lathsome, degrading and unholly. There is no divorce, and there ought to be no human law to compel the continuance of any marriage which, so long as it continues, is nothing better than legalized prostitution.

To which the Adverser replies: This is the essential doctrine of free love set forth in the usual platitudes and sentimental form: it is a direct denial of the Bible doctrine of marriage as an indissoluble union.

The free-love man by the union of affluence, which is dissoluble when the affluence ceases to be a fact and is replaced with dislike. The defense made is principally threefold.

(1) The laws of our State take the same view with the editor of the Independent and allow many other reasons for divorce than adultery. Very true, and this is precisely the reason that the intensely religious should seek to purify such legislation. Is there any other subject on which State legislation is a standard of morals?

(2) Some of the early reformers indulged similarly loose views of divorce. True again; but that fact - induced by excessive reaction from Puritan doctrine, and a desire to favor the views and conduct of certain Protestant reformers - was in the early stages of Biblical criticism, and has been for those centuries standing reproach to Protestantism.

(3) John Milton is put forward (as we know he would be, to plead for free divorce) in the hope that his ability as a scholar and a poet, and his renown as a Puritan politician would turn his heterodoxy on this point into orthodoxy. But they cannot, any more than they can recommend his alleged Arrianism.

The truth is, that Milton employed his wealth of learning and rhetoric in getting up a special plea to cover his own conduct. The editor of his prose writings, who shares his opinions, says of his treatise on this subject: "While occasionally engaged in discussing the question generally and upon public grounds, he was, it is well known, pleading his own case."

It is somewhat as though Mrs. Stowland were to publish a treatise on Divorce. (It is intimated that the Greek word for "prostitution" is in the only Greek dictionary allowed by Christ, in the only Greek dictionary in the wide acceptance of anything contrary to the spirit of marriage.)

Can the Independent show the contrary? (It is claimed that experience in France of no divorce, and in Prussia of only divorce shows the latter to be much more favorable to morality.)

But why take either extreme, both being against Scripture? Moreover, such is "the lax and demoralizing" effect of modern Prussian law which began "in the infidel reign of Frederick II., that the Christians of Prussia have started a reform movement "which aims at a return to the law of Christ."

Thus the show of reasons by the Independent will satisfy no thinking mind which has true reverence for the word of God as final authority on all points of faith and morals.

Amusements. A New York paper congratulating the people of the city on the new building just completed for the Young Men's Christian Association, says: One very commendable feature in the scheme of his admirable institution is that it recognizes the real and natural need for amusements as well as for instruction in those for whose benefit it exists, and the urgency for physical as well as spiritual culture that presses upon them.

When amusement is once recognized to be a want of adollescent human nature, and the prevailing amusements are found or fancied to be tainted with elements which vitiate them, it follows that pure amusements become a great desideratum.

The Louisville Mystery.

The ancient published yesterday in the morning of a large amount of hidden treasure, on the banks of the Ohio, near the new bridge over the Ohio river, excited general excitement, and hundreds visited the spot yesterday, including a large number of Ladies. Many were at first, fainthearted to doubt the truth of the story, but an inspection of the hut, the large hole from which the treasure had been taken, and the straightforward testimony of the watchman at the bridge, and other persons who had gazed upon the singular contents of the mysterious hoard, convinced the most skeptical. The statement of the watchman who occupies the little watch-house just at the end of the bridge, a point commanding a full view of the banks of the river for some distance, and to whose little old, withered doctar made numerous applications for the use of the line house, is remarkably straightforward, and of so ample amount of questioning could elicit anything but the plain, simple statement that he had seen the doctar surveying the ground, saw the hut built and the light shining through the shinks at all hours of the night. On last Wednesday night, during the terrible snow storm which our readers will remember prevailed on that night, he was called, upon to open the draw-span of the bridge over the canal to allow a steamboat to pass, and while so engaged he saw the light gleaming through the cracks of the shinks, and was compelled to remain out in the storm, out of from his cosy watch-house until daylight revealed his uncomfortable and perilous position. During the long watches of that dismal night he saw the light gleaming through the cracks of the shinks, and was determined to investigate the matter. The next night the two men emerged from the hut with their precious burden, placed it in a wagon, and hurried away, and were seen to enter the canal at the opening of the shed and the revealing of the excavation and the implements used in the work. A close examination brought to light the "decayed" post with the singular looking brass nail driven the top. These were all that were left to tell the tale of the days and nights of eager search for the hidden treasure.

The publication of the narrative brought civility to the memory of many of our oldest citizens the long forgotten story of the many searches made in years past for this same mine of wealth.

One of our oldest and most respected citizens, who has held many responsible trusts under the city government, informed us that he remembered distinctly the excitement that was created some 25 or 30 years ago by the alleged murder and robbery of a wealthy Cuban or Spaniard, and that a notorious character, known as French Joe, who lived at or near the old mill-gate, on the Shippingport road, was strongly suspected of the crime.

It was impossible to obtain conclusive evidence of his guilt, and he was allowed to go unpunished. He also remembers the finding in the river of the naked body of a dark, mysterious looking man, whom one could identify, about the time the murder was said to have been committed. Other circumstances have recently transpired which throw additional light upon the subject, and may lead to the full development of the whole affair, which is now so darkly shrouded in mystery.

About two weeks ago, the police authorities received information that of the most noted thieves and burglars in the country, whose name we have, but which we suppress in order that the ends of justice may not be defeated - was in the city, and although the shrewdest detectives were put on his track, he managed to elude them, but they made the piece so warm for him that he was compelled to leave the city. Since the time which all trace of him has been lost, which was on Friday last, it has leaked out through the love for gossip of a frail woman with whom he was known to have been an intimate friend in the past, that before he left the city he deposited \$200,000, principally in gold coin, for safe-keeping. The money had been brought abroad among his frail sisters, and finally reached the ears of the detectives, and upon searching for her in the haunts of dissipation she could not be found. The detectives who have the matter in hand are confident that she has not left the city, but that, fearful of the consequences of her indiscretion in speaking of the matter, she is hiding in some obscure portion of the city.

The description given by one of the bridge men of the rough-looking man who assumed the old doctar's dress exactly with that of the mysterious thief, who it is known could not have come honestly by such a large sum of money, and who, unless hard pressed by the officers, would not have deposited it with a frail woman. These facts lead the detectives in the belief that they are on the right scent, and a reasonable hope that the whole transaction will be brought to light.

It is well known that the enlargement of the canal will necessitate the excavation of that portion of the bank where the treasure is supposed to have been found, and this not having been widely published, doubtless determined the possessors of the hoard to return and make another attempt to recover the treasure, and all the circumstances of the case lead to the belief that this attempt was successful. - Courier Journal, Dec. 20.

What the Soldiers are Thinking.

General Morgan, of Ohio, one of the most gallant soldiers of the war at Gettysburg, is now in Congress, and what other soldiers will do in the future, is a matter of some interest.

Items.

The Vermont State Temperance Society has voted that should the case of James M. Hays be decided in his favor, he should be pardoned, and that the restoration of his name to the roll of the society should be the result of the formation of a committee for other similar cases.

Lenox, Dec. 31. - "Historian" of the Times, has an article to-day assailing the dispatch of Secretary Fish as the Alabama question.

The weekly Spectator has an article on the Alabama difficulty. It says that when the north of the American's struggle was under way, England refused her sympathies to the south, and that the restorations now based on the earliest wrongs are simply unjustly vindictive.

An important petition has been handed to the President, signed by the leading property-holders at Victoria, Vancouver Island, and other places in the neighborhood, and praying for the transfer of British Columbia to the United States. Senator Semer preside that the movement will terminate in an annexation, and the President has returned a reply to the petitioners, assuring them of his great interest in the matter.

Col. P. F. Fishels, chief of the Choctaw tribe of Indians, has made a protest before the commissioner of Indian Affairs, in behalf of his tribe, against a violation of the treaty made with that tribe, by collecting the internal revenue tax in that country. This was induced by the seizure of a tobacco factory a few days ago.

A number of gentlemen in Kansas, N. H., engaged in fish-culture, have, as the result of about two years' experiment, 100,000 trout in their ponds, covering about one and a half acres.

According to the Rome correspondent of the London Times, the influence of the Pope over the Ecumenical Council is slowly growing weaker. It was a danger apprehended by the Cardinal Antonelli and other shrewd advisers of his Holiness that the Council might take the lead in its own hands if it were some together. The dogma of the Papal infallibility, which the Pope has so much at heart, is threatened by the persistent energy of the liberal bishops.

The model State of the Union, financially considered, is Iowa. By January 1st she will be out of debt, and have a surplus of half a million dollars in the State Treasury.

A colored gentleman in Texas, with his coat-pockets full of powder, recently visited the deer and came out through the roof.

Nashville, Tenn., Dec. 31. - A commission of federal officers convened here this morning to investigate frauds alleged to have been practiced by claim agents in collecting the bounty and back pay of colored soldiers. It is thought that hundreds of thousands of dollars have been derived from the pockets of the class of soldiers.

Representative Lagervall expresses considerable confidence that his bill to increase the circulation of legal-tenders \$40,000,000 will pass the house, but he is not quite so certain of its success in the senate. A test vote on increasing the volume of currency will be again attempted in the house soon after congress assembles.

In response to an inquiry by the Radical member of Congress who introduced a proposition into the House to present every Southern negro with forty acres of the public lands and a mule, the Department of the Interior has furnished a statement of the number of uncolored acres of public lands in the South. The total amount is 47,479,019 acres, which, divided among four millions of negroes, gives each the requisite forty acres. It is enough over to buy the mule. One half of the land is situated in the swamps of Florida and the underbrush of Arkansas; five countries for negro settlements.

Mrs. Harriet Beecher Stowe has come to the defense of her reputation at last. Her reply in the savage articles who have assailed her, and her former tearing to pieces of the character of Lord Byron, will appear in book-form, that being the mode by which the largest sum of money can be realized from the speculation. His promise to prove every accusation made against Byron, and more too, and to utterly confound the newspaper commentators, whose distributives, she says, she has never taken the trouble to read.

Three persons belonging to a family of Germans living twenty miles southeast of Heidelberg, Ill., had died from eating trichina pork. Eight other persons, who had eaten the same, and will probably all die. The trichina can be seen in immense numbers in the meat, and also in the flesh of those who have died.

The Impression is growing in Washington that the Cuban insurrection is near its end. All private reports present the insurgents as growing weaker daily.

A woman in Kentucky, 80 years of age, is cutting her third set of teeth. She uses nothing but soap and water for a baby on washing-day.

The latest description of Mr. Greeley's necktie: - It looked as if it had grown upon his shirt-collar like a mushroom, and had been torn to pieces in a halcyon.

Abraham McCloskey is appointed as the head of the committee on discipline, which is in report to the Ecumenical council. There are about a score of bishops from all countries on this committee.

The Egyptian Viceroy presides in town with contempt the demands of his own at Constantinople, and the rage of the Sultan Pasha, who has forwarded Alexander a violent message, demands Ibrahim Pasha to abandon his own seat. If the Viceroy fulfills his duty in a few independent, there will shortly be a cutting in the Levant. The exiled resident which he has honored his own master indicates a solid contained the prospect of a future struggle.

In Wall street on Friday last the Secretary of the Treasury received a remittance of \$120,000. This amounting by every calculation a half of dollars were added, but only 25 of the amount were accepted, the 5 with that exception being below 120,000, and at the board on 110, and at the board at 120. The money market is very quiet. Stocks were depressed. Government improved.

Mrs. Lincoln, says, Frankfurt paper reports in Berlin, where she has been some time.

Harriet Grote, in the last Independent writes that the Temperance party, as a national organization is dead.

Great Britain.

Liverpool, Jan. 1. - The Spectator, writing on the recent diplomatic correspondence between the governments of the United Kingdom and Great Britain, says that "the Secretary of State is imprudent in his own sense, his disposition is not so happy as formerly. Yet there is too much dignified and sentimental complaint of a class otherwise to legal question American sense on the Alabama question wrong, and one in which all powers are deeply interested, but it does not do it justice."

The Mercury Review, referring to a home dispatch, says: "The Americans that they abandoned no part properly, since to interfere with their vessels in the blockaded port of Cuba." The Times gravely predicts a pro-commercial year, because midway the troubles of 1869 and the period a new inflation is on, American excluded from the European market action of the judiciary and the legis New York regarding the Erie; and securities will lose their demand in because of their advanced price.

British Taxation.

Nearly the whole revenue of the empire from customs is derived from articles, and ninety-six and a half, of the revenue from excise comes from tax, malt and license.

The British income tax is a little over two per cent, but yields in gold, 5 as much as ours; and the whole of the kingdom is considerably in excess of the United States, although we have hundreds of articles where Great Britain has not. Yet the revenues of the British are not practically very different.

England has tried both plans; which we follow, of adjusting duties so as to protect and help everything secondly, that of selecting a few a tax, solely for revenue purposes. Her plan she now collects more revenue cheaper, and with incomparably less injury on the people, than she ever the former.

A New York paper thus no speech of Mayor Hall at the New dinner in that city:

Not only did the Mayor evince to compatibility of classical learning and practical functions, but he demonstrated asemblage, that, but for a little tree the part of the pilot, the portions of flower would have landed on Governor, instead of Plymouth Rock. I river and our beloved Isle were its passed destination. Mr. Hall's brilliant are conclusive on this point, show us the peril from which the city narrowly escaped. If they had a er, they would have whittled and bereaved every Dutchman of the island the space of one calendar year; so earlier traditions of the metropolis are those of a mildy gluttonous as people, who sat at their doors and loved pipes, and subsisted upon brood and snags, would have been assured of loss and hungry wails, show us the peril from which the city narrowly escaped. If they had a er, they would have whittled and bereaved every Dutchman of the island the space of one calendar year; so earlier traditions of the metropolis are those of a mildy gluttonous as people, who sat at their doors and loved pipes, and subsisted upon brood and snags, would have been assured of loss and hungry wails, show us the peril from which the city narrowly escaped. If they had a er, they would have whittled and bereaved every Dutchman of the island the space of one calendar year; so earlier traditions of the metropolis are those of a mildy gluttonous as people, who sat at their doors and loved pipes, and subsisted upon brood and snags, would have been assured of loss and hungry wails, show us the peril from which the city narrowly escaped. If they had a er, they would have whittled and bereaved every Dutchman of the island the space of one calendar year; so earlier traditions of the metropolis are those of a mildy gluttonous as people, who sat at their doors and loved pipes, and subsisted upon brood and snags, would have been assured of loss and hungry wails, show us the peril from which the city narrowly escaped. If they had a er, they would have whittled and bereaved every Dutchman of the island the space of one calendar year; so earlier traditions of the metropolis are those of a mildy gluttonous as people, who sat at their doors and loved pipes, and subsisted upon brood and snags, would have been assured of loss and hungry wails, show us the peril from which the city narrowly escaped. If they had a er, they would have whittled and bereaved every Dutchman of the island the space of one calendar year; so earlier traditions of the metropolis are those of a mildy gluttonous as people, who sat at their doors and loved pipes, and subsisted upon brood and snags, would have been assured of loss and hungry wails, show us the peril from which the city narrowly escaped. If they had a er, they would have whittled and bereaved every Dutchman of the island the space of one calendar year; so earlier traditions of the metropolis are those of a mildy gluttonous as people, who sat at their doors and loved pipes, and subsisted upon brood and snags, would have been assured of loss and hungry wails, show us the peril from which the city narrowly escaped. If they had a er, they would have whittled and bereaved every Dutchman of the island the space of one calendar year; so earlier traditions of the metropolis are those of a mildy gluttonous as people, who sat at their doors and loved pipes, and subsisted upon brood and snags, would have been assured of loss and hungry wails, show us the peril from which the city narrowly escaped. If they had a er, they would have whittled and bereaved every Dutchman of the island the space of one calendar year; so earlier traditions of the metropolis are those of a mildy gluttonous as people, who sat at their doors and loved pipes, and subsisted upon brood and snags, would have been assured of loss and hungry wails, show us the peril from which the city narrowly escaped. If they had a er, they would have whittled and bereaved every Dutchman of the island the space of one calendar year; so earlier traditions of the metropolis are those of a mildy gluttonous as people, who sat at their doors and loved pipes, and subsisted upon brood and snags, would have been assured of loss and hungry wails, show us the peril from which the city narrowly escaped. If they had a er, they would have whittled and bereaved every Dutchman of the island the space of one calendar year; so earlier traditions of the metropolis are those of a mildy gluttonous as people, who sat at their doors and loved pipes, and subsisted upon brood and snags, would have been assured of loss and hungry wails, show us the peril from which the city narrowly escaped. If they had a er, they would have whittled and bereaved every Dutchman of the island the space of one calendar year; so earlier traditions of the metropolis are those of a mildy gluttonous as people, who sat at their doors and loved pipes, and subsisted upon brood and snags, would have been assured of loss and hungry wails, show us the peril from which the city narrowly escaped. If they had a er, they would have whittled and bereaved every Dutchman of the island the space of one calendar year; so earlier traditions of the metropolis are those of a mildy gluttonous as people, who sat at their doors and loved pipes, and subsisted upon brood and snags, would have been assured of loss and hungry wails, show us the peril from which the city narrowly escaped. If they had a er, they would have whittled and bereaved every Dutchman of the island the space of one calendar year; so earlier traditions of the metropolis are those of a mildy gluttonous as people, who sat at their doors and loved pipes, and subsisted upon brood and snags, would have been assured of loss and hungry wails, show us the peril from which the city narrowly escaped. If they had a er, they would have whittled and bereaved every Dutchman of the island the space of one calendar year; so earlier traditions of the metropolis are those of a mildy gluttonous as people, who sat at their doors and loved pipes, and subsisted upon brood and snags, would have been assured of loss and hungry wails, show us the peril from which the city narrowly escaped. If they had a er, they would have whittled and bereaved every Dutchman of the island the space of one calendar year; so earlier traditions of the metropolis are those of a mildy gluttonous as people, who sat at their doors and loved pipes, and subsisted upon brood and snags, would have been assured of loss and hungry wails, show us the peril from which the city narrowly escaped. If they had a er, they would have whittled and bereaved every Dutchman of the island the space of one calendar year; so earlier traditions of the metropolis are those of a mildy gluttonous as people, who sat at their doors and loved pipes, and subsisted upon brood and snags, would have been assured of loss and hungry wails, show us the peril from which the city narrowly escaped. If they had a er, they would have whittled and bereaved every Dutchman of the island the space of one calendar year; so earlier traditions of the metropolis are those of a mildy gluttonous as people, who sat at their doors and loved pipes, and subsisted upon brood and snags, would have been assured of loss and hungry wails, show us the peril from which the city narrowly escaped. If they had a er, they would have whittled and bereaved every Dutchman of the island the space of one calendar year; so earlier traditions of the metropolis are those of a mildy gluttonous as people, who sat at their doors and loved pipes, and subsisted upon brood and snags, would have been assured of loss and hungry wails, show us the peril from which the city narrowly escaped. If they had a er, they would have whittled and bereaved every Dutchman of the island the space of one calendar year; so earlier traditions of the metropolis are those of a mildy gluttonous as people, who sat at their doors and loved pipes, and subsisted upon brood and snags, would have been assured of loss and hungry wails, show us the peril from which the city narrowly escaped. If they had a er, they would have whittled and bereaved every Dutchman of the island the space of one calendar year; so earlier traditions of the metropolis are those of a mildy gluttonous as people, who sat at their doors and loved pipes, and subsisted upon brood and snags, would have been assured of loss and hungry wails, show us the peril from which the city narrowly escaped. If they had a er, they would have whittled and bereaved every Dutchman of the island the space of one calendar year; so earlier traditions of the metropolis are those of a mildy gluttonous as people, who sat at their doors and loved pipes, and subsisted upon brood and snags, would have been assured of loss and hungry wails, show us the peril from which the city narrowly escaped. If they had a er, they would have whittled and bereaved every Dutchman of the island the space of one calendar year; so earlier traditions of the metropolis are those of a mildy gluttonous as people, who sat at their doors and loved pipes, and subsisted upon brood and snags, would have been assured of loss and hungry wails, show us the peril from which the city narrowly escaped. If they had a er, they would have whittled and bereaved every Dutchman of the island the space of one calendar year; so earlier traditions of the metropolis are those of a mildy gluttonous as people, who sat at their doors and loved pipes, and subsisted upon brood and snags, would have been assured of loss and hungry wails, show us the peril from which the city narrowly escaped. If they had a er, they would have whittled and bereaved every Dutchman of the island the space of one calendar year; so earlier traditions of the metropolis are those of a mildy gluttonous as people, who sat at their doors and loved pipes, and subsisted upon brood and snags, would have been assured of loss and hungry wails, show us the peril from which the city narrowly escaped. If they had a er, they would have whittled and bereaved every Dutchman of the island the space of one calendar year; so earlier traditions of the metropolis are those of a mildy gluttonous as people, who sat at their doors and loved pipes, and subsisted upon brood and snags, would have been assured of loss and hungry wails, show us the peril from which the city narrowly escaped. If they had a er, they would have whittled and bereaved every Dutchman of the island the space of one calendar year; so earlier traditions of the metropolis are those of a mildy gluttonous as people, who sat at their doors and loved pipes, and subsisted upon brood and snags, would have been assured of loss and hungry wails, show us the peril from which the city narrowly escaped. If they had a er, they would have whittled and bereaved every Dutchman of the island the space of one calendar year; so earlier traditions of the metropolis are those of a mildy gluttonous as people, who sat at their doors and loved pipes, and subsisted upon brood and snags, would have been assured of loss and hungry wails, show us the peril from which the city narrowly escaped. If they had a er, they would have whittled and bereaved every Dutchman of the island the space of one calendar year; so earlier traditions of the metropolis are those of a mildy gluttonous as people, who sat at their doors and loved pipes, and subsisted upon brood and snags, would have been assured of loss and hungry wails, show us the peril from which the city narrowly escaped. If they had a er, they would have whittled and bereaved every Dutchman of the island the space of one calendar year; so earlier traditions of the metropolis are those of a mildy gluttonous as people, who sat at their doors and loved pipes, and subsisted upon brood and snags, would have been assured of loss and hungry wails, show us the peril from which the city narrowly escaped. If they had a er, they would have whittled and bereaved every Dutchman of the island the space of one calendar year; so earlier traditions of the metropolis are those of a mildy gluttonous as people, who sat at their doors and loved pipes, and subsisted upon brood and snags, would have been assured of loss and hungry wails, show us the peril from which the city narrowly escaped. If they had a er, they would have whittled and bereaved every Dutchman of the island the space of one calendar year; so earlier traditions of the metropolis are those of a mildy gluttonous as people, who sat at their doors and loved pipes, and subsisted upon brood and snags, would have been assured of loss and hungry wails, show us the peril from which the city narrowly escaped. If they had a er, they would have whittled and bereaved every Dutchman of the island the space of one calendar year; so earlier traditions of the metropolis are those of a mildy gluttonous as people, who sat at their doors and loved pipes, and subsisted upon brood and snags, would have been assured of loss and hungry wails, show us the peril from which the city narrowly escaped. If they had a er, they would have whittled and bereaved every Dutchman of the island the space of one calendar year; so earlier traditions of the metropolis are those of a mildy gluttonous as people, who sat at their doors and loved pipes, and subsisted upon brood and snags, would have been assured of loss and hungry wails, show us the peril from which the city narrowly escaped. If they had a er, they would have whittled and bereaved every Dutchman of the island the space of one calendar year; so earlier traditions of the metropolis are those of a mildy gluttonous as people, who sat at their doors and loved pipes, and subsisted upon brood and snags, would have been assured of loss and hungry wails, show us the peril from which the city narrowly escaped. If they had a er, they would have whittled and bereaved every Dutchman of the island the space of one calendar year; so earlier traditions of the metropolis are those of a mildy gluttonous as people, who sat at their doors and loved pipes, and subsisted upon brood and snags, would have been assured of loss and hungry wails, show us the peril from which the city narrowly escaped. If they had a er, they would have whittled and bereaved every Dutchman of the island the space of one calendar year; so earlier traditions of the metropolis are those of a mildy gluttonous as people, who sat at their doors and loved pipes, and subsisted upon brood and snags, would have been assured of loss and hungry wails, show us the peril from which the city narrowly escaped. If they had a er, they would have whittled and bereaved every Dutchman of the island the space of one calendar year; so earlier traditions of the metropolis are those of a mildy gluttonous as people, who sat at their doors and loved pipes, and subsisted upon brood and snags, would have been assured of loss and hungry wails, show us the peril from which the city narrowly escaped. If they had a er, they would have whittled and bereaved every Dutchman of the island the space of one calendar year; so earlier traditions of the metropolis are those of a mildy gluttonous as people, who sat at their doors and loved pipes, and subsisted upon brood and snags, would have been assured of loss and hungry wails, show us the peril from which the city narrowly escaped. If they had a er, they would have whittled and bereaved every Dutchman of the island the space of one calendar year; so earlier traditions of the metropolis are those of a mildy gluttonous as people, who sat at their doors and loved pipes, and subsisted upon brood and snags, would have been assured of loss and hungry wails, show us the peril from which the city narrowly escaped. If they had a er, they would have whittled and bereaved every Dutchman of the island the space of one calendar year; so earlier traditions of the metropolis are those of a mildy gluttonous as people, who sat at their doors and loved pipes, and subsisted upon brood and snags, would have been assured of loss and hungry wails, show us the peril from which the city narrowly escaped. If they had a er, they would have whittled and bereaved every Dutchman of the island the space of one calendar year; so earlier traditions of the metropolis are those of a mildy gluttonous as people, who sat at their doors and loved pipes, and subsisted upon brood and snags, would have been assured of loss and hungry wails, show us the peril from which the city narrowly escaped. If they had a er, they would have whittled and bereaved every Dutchman of the island the space of one calendar year; so earlier traditions of the metropolis are those of a mildy gluttonous as people, who sat at their doors and loved pipes, and subsisted upon brood and snags, would have been assured of loss and hungry wails, show us the peril from which the city narrowly escaped. If they had a er, they would have whittled and bereaved every Dutchman of the island the space of one calendar year; so earlier traditions of the metropolis are those of a mildy gluttonous as people, who sat at their doors and loved pipes, and subsisted upon brood and snags, would have been assured of loss and hungry wails, show us the peril from which the city narrowly escaped. If they had a er, they would have whittled and bereaved every Dutchman of the island the space of one calendar year; so earlier traditions of the metropolis are those of a mildy gluttonous as people, who sat at their doors and loved pipes, and subsisted upon brood and snags, would have been assured of loss and hungry wails, show us the peril from which the city narrowly escaped. If they had a er, they would have whittled and bereaved every Dutchman of the island the space of one calendar year; so earlier traditions of the metropolis are those of a mildy gluttonous as people, who sat at their doors and loved pipes, and subsisted upon brood and snags, would have been assured of loss and hungry wails, show us the peril from which the city narrowly escaped. If they had a er, they would have whittled and bereaved every Dutchman of the island the space of one calendar year; so earlier traditions of the metropolis are those of a mildy gluttonous as people, who sat at their doors and loved pipes, and subsisted upon brood and snags, would have been assured of loss and hungry wails, show us the peril from which the city narrowly escaped. If they had a er, they would have whittled and bereaved every Dutchman of the island the space of one calendar year; so earlier traditions of the metropolis are those of a mildy gluttonous as people, who sat at their doors and loved pipes, and subsisted upon brood and snags, would have been assured of loss and hungry wails, show us the peril from which the city narrowly escaped. If they had a er, they would have whittled and bereaved every Dutchman of the island the space of one calendar year; so earlier traditions of the metropolis are those of a mildy gluttonous as people, who sat at their doors and loved pipes, and subsisted upon brood and snags, would have been assured of loss and hungry wails, show us the peril from which the city narrowly escaped. If they had a er, they would have whittled and bereaved every Dutchman of the island the space of one calendar year; so earlier traditions of the metropolis are those of a mildy gluttonous as people, who sat at their doors and loved pipes, and subsisted upon brood and snags, would have been assured of loss and hungry wails, show us the peril from which the city narrowly escaped. If they had a er, they would have whittled and bereaved every Dutchman of the island the space of one calendar year; so earlier traditions of the metropolis are those of a mildy gluttonous as people, who sat at their doors and loved pipes, and subsisted upon brood and snags, would have been assured of loss and hungry wails, show us the peril from which the city narrowly escaped. If they had a er, they would have whittled and bereaved every Dutchman of the island the space of one calendar year; so earlier traditions of the metropolis are those of a mildy gluttonous as people, who sat at their doors and loved pipes, and subsisted upon brood and snags, would have been assured of loss and hungry wails, show us the peril from which the city narrowly escaped. If they had a er, they would have whittled and bereaved every Dutchman of the island the space of one calendar year; so earlier traditions of the metropolis are those of a mildy gluttonous as people, who sat at their doors and loved pipes, and subsisted upon brood and snags, would have been assured of loss and hungry wails, show us the peril from which the city narrowly escaped. If they had a er, they would have whittled and bereaved every Dutchman of the island the space of one calendar year; so earlier traditions of the metropolis are those of a mildy gluttonous as people, who sat at their doors and loved pipes, and subsisted upon brood and snags, would have been assured of loss and hungry wails, show us the peril from which the city narrowly escaped. If they had a er, they would have whittled and bereaved every Dutchman of the island the space of one calendar year; so earlier traditions of the metropolis are those of a mildy gluttonous as people, who sat at their doors and loved pipes, and subsisted upon brood and snags, would have been assured of loss and hungry wails, show us the peril from which the city narrowly escaped. If they had a er, they would have whittled and bereaved every Dutchman of the island the space of one calendar year; so earlier traditions of the metropolis are those of a mildy gluttonous as people, who sat at their doors and loved pipes, and subsisted upon brood and snags, would have been assured of loss and hungry wails, show us the peril from which the city narrowly escaped. If they had a er, they would have whittled and bereaved every Dutchman of the island the space of one calendar year; so earlier traditions of the metropolis are those of a mildy gluttonous as people, who sat at their doors and loved pipes, and subsisted upon brood and snags, would have been assured of loss and hungry wails, show us the peril from which the city narrowly escaped. If they had a er, they would have whittled and bereaved every Dutchman of the island the space of one calendar year; so earlier traditions of the metropolis are those of a mildy gluttonous as people, who sat at their doors and loved pipes, and subsisted upon brood and snags, would have been assured of loss and hungry wails, show us the peril from which the city narrowly escaped. If they had a er, they would have whittled and bereaved every Dutchman of the island the space of one calendar year; so earlier traditions of the metropolis are those of a mildy gluttonous as people, who sat at their doors and loved pipes, and subsisted upon brood and snags, would have been assured of loss and hungry wails, show us the peril from which the city narrowly escaped. If they had a er, they would have whittled and bereaved every Dutchman of the island the space of one calendar year; so earlier traditions of the metropolis are those of a mildy gluttonous as people, who sat at their doors and loved pipes, and subsisted upon brood and snags, would have been assured of loss and hungry wails, show us the peril from which the city narrowly escaped. If they had a er, they would have whittled and bereaved every Dutchman of the island the space of one calendar year; so earlier traditions of the metropolis are those of a mildy gluttonous as people, who sat at their doors and loved pipes, and subsisted upon brood and snags, would have been assured of loss and hungry wails, show us the peril from which the city narrowly escaped. If they had a er, they would have whittled and bereaved every Dutchman of the island the space of one calendar year; so earlier traditions of the metropolis are those of a mildy gluttonous as people, who sat at their doors and loved pipes, and subsisted upon brood and snags, would have been assured of loss and hungry wails, show us the peril from which the city narrowly escaped. If they had a er, they would have whittled and bereaved every Dutchman of the island the space of one calendar year; so earlier traditions of the metropolis are those of a mildy gluttonous as people, who sat at their doors and loved pipes, and subsisted upon brood and snags, would have been assured of loss and hungry wails, show us the peril from which the city narrowly escaped. If they had a er, they would have whittled and bereaved every Dutchman of the island the space of one calendar year; so earlier traditions of the metropolis are those of a mildy gluttonous as people, who sat at their doors and loved pipes, and subsisted upon brood and snags, would have been assured of loss and hungry wails, show us the peril from which the city narrowly escaped. If they had a er, they would have whittled and bereaved every Dutchman of the island the space of one calendar year; so earlier traditions of the metropolis are those of a mildy gluttonous as people, who sat at their doors and loved pipes, and subsisted upon brood and snags, would have been assured of loss and hungry wails, show us the peril from which the city narrowly escaped. If they had a er, they would have whittled and bereaved every Dutchman of the island the space of one calendar year; so earlier traditions of the metropolis are those of a mildy gluttonous as people, who sat at their doors and loved pipes, and subsisted upon brood and snags, would have been assured of loss and hungry wails, show us the peril from which the city narrowly escaped. If they had a er, they would have whittled and bereaved every Dutchman of the island the space of one calendar year; so earlier traditions of the metropolis are those of a mildy gluttonous as people, who sat at their doors and loved pipes, and subsisted upon brood and snags, would have been assured



er-vice to them the al learning with mu- demonstrated to the a little treachery on puritans of the May- ed on Governor's Is- th Rock. Our noble isle were their pro- Hall's historical ci- a this point, and they which the metropolis if they had come bith- tilled and traded and off the Island within er year; so that the e metropolis, which luttonous and rotund r doors and smoked ed upon krullers and ld have been of a con- gry saints, who sung eir noses and inter- bors as long as the rhodies. Mr. Jones, aints ashore on Ply- the course of history t of which he did not reminder of that cir- ken in the metropol- thankfulness at our ad of emigrants.

rls of Dover, New work, and through Miss Collins, tell a pit- and beggarly wages. e sent letters of con- er, and the commotion nity is one of unusual s of the treatment of ly of children, in New e shown a system of qual to anything prac- it was "the privilege p his own nigger."— said about the mean their meanness arises ance. It is not of the which educates men sharp bargains with hed, poverty stricken

rary entertainment of oter has been arrang- er in Boston. A course d, in which, on every oturers shall present issues. Professor Per- e Trade and Horace ov. Gilbert Haven will oman's Suffrage, and ppose the innovation. t forth the humanita- and Rev. Mr. Town- cinterian theory. A id prominent Republi- to represent the views

Kalamazoo township has voted, by a major- ity of 25, \$25,000 aid to the Jonesville, Mar- shall and Grand River railroad. The con- test was very spirited, and the victory well earned.

The Hillsdale Standard says: Changes in church relations are becoming quite common. Since the announcement of President Fairfield's withdrawal from the F. W. B. Church we notice that Rev. R. W. Lockhart editor of the Reading Re- view, has left the Regular Baptist Church and joined the Freewills. Well, "Change is written upon everything."

It appears that the salaries of government officers in the little state of Florida are larger than in any other state east of the Rocky mountains. The governor gets \$5,000; his cabinet, in all, \$24,000, and the legislature, \$500 per annum, or, allowing 30 days to the session, \$12.50 per day!

**Married.**

In this city, January 1st, 1870, by Rev. A. W. Curtis, of the Wesleyan M. Church, Mr. EZEKIEL J. PARMOUR, of Hudson, Mich., and Miss LYDIA ANN SUTTON, of this city.

**MARKET REPORT.**

Corrected weekly by Warren & Wilson, Deal- ers in Teas, Notions, Nuts, Candies, Bas- kets, Groceries and Provisions. Cash at all times paid for Butter, Eggs, Dried and Green Fruit, &c. Flour (warranted good;) Corn and Oat-Meal, Coarse and Fine Salt by the pound or barrel, and full proof Ker- osene Oil always on hand at the lowest mar- ket price.

Wheat, white, 7 1/2 bu., No. 1,.... \$	90
Wheat, white, 7 1/2 bu., No. 2,....	@ 80
Wheat, red, 7 1/2 bu.,.....	80 @ —
Buckwheat,.....	75 @ 80
Corn, in the ear, 7 1/2 bushel,....	65 @ 70
Corn, shelled, 7 1/2 bushel,.....	70 @ 75
Oats, per bushel,.....	40 @ 45
Barley, 7 1/2 100 pounds,.....	1.50 @
Beans, 7 1/2 bushel,.....	75 @ 1.25
Flax Seed, 7 1/2 bushel,.....	2.00
Clover Seed, 7 1/2 bushel,.....	6.75 @
Potatoes, 7 1/2 bushel,.....	25 @ 30
Apples, green, 7 1/2 bushel,.....	50 @ 75
Apples, dried, 7 1/2 pound,.....	9 @ 10
Peach, pared, 7 1/2 pound,.....	14 @ 15
Cherries, dried, 7 1/2 pound,.....	@ 25
Raspberries, 7 1/2 pound,.....	@ 30
Blackberries, 7 1/2 pound,.....	11 @ 12
Butter, fresh made, roll, 7 1/2 lb.,..	25 @ 27
Butter, crock and tub, 7 1/2 lb.,...	25 @ 27
Butter, extra, in tubs, (Ashford Salt,) shaded,.....	— @ —
Eggs, 7 1/2 dozen,.....	28 @ 30
Pork, green, 7 1/2 cwt,.....	9 @ 10
Hams, smoked, 7 1/2 pound,.....	— @ —
Shoulders, smoked, 7 1/2 pound,...	— @ —

complainant's solicitor within twenty days after service of a copy of said bill, and in default thereof said bill may be taken as confessed by him.

CHAS. UPSON, Circuit Judge.  
E. G. PULLER, Solicitor. 3817

**NOTICE.**

A CORDIAL invitation is extended to all persons indebted to GEO. K. SMITH, to call at once and settle. J. W. FISK, Assignee. December 22d, 1869. 36m2

**LARGEST—BEST—CHEAPEST!**

**MOORE'S RURAL NEW-YORKER.**  
THE GREAT ILLUSTRATED  
**Rural and Family Newspaper.**

**Volume XXI., for 1870,**

Of this Famous Journal will excel in all the valuable essentials and characteristics of a First-Class Rural Literary, Family and Business Newspaper, combined—making it the

**NAPOLEON OF ITS CLASS!**

The RURAL was Doubled in Size and Vastly Im- proved, in Jan. last, and is now not only the Largest, Cheapest and Best, but also the Largest Circulating Weekly in its Sphere. Superior in Ability Value and Variety of Contents, as well as in Size Style and Illustrations, and having a Conti- nental Circulation—with tens of thousands of ardent admirers in both Town and Country—the RURAL is the great

**FARM & FIRESIDE FAVORITE.**

Employing the Best Talent in the Land—having Nine Able Editors and Hundreds of Special Contributors and Correspondents—and being an acknowledged authority on Practical, Scientific and Literary subjects, an Ex- change truly says of it that "The RURAL is the most Elegantly Printed, Ably Edited, Widely Circulated and Heartily Welcomed Paper, as a whole, which now finds its way among the People."

**MOORE'S RURAL PAYS**

All who cultivate Fruits, Flowers, Vegetables, &c. even on a small scale, (in City, Village or Suburb) whil- to Farmers, Planters, Horticulturists, Stock Breeders, Wool Growers, Dairymen, Poultry fanciers, &c., it is INDISPENSABLE. In the FAMILY it is highly regard- ed, its Literary and Miscellaneous Departments fur- nishing CHOICE AND ENTERTAINING READING FOR ALL. The RURAL'S

**MARKET AND CROP REPORTS**

Are full and reliable. Indeed, being Ably Edited, Il- lustrated and Printed in Extra Style, and Adapted to Country, Village and City, the RURAL is the Paper for Yourself, Family and Friends. Remember that it is not a monthly, but the Largest, Cheapest and Best Illustrated Weekly, and that, though don't be its former size, and greatly improved, its Subscrip- tion Price remains unchanged!

**FORM, STYLE, TERMS, &c.**

vol. XXI., for 1870, will be published in Super- ity, each number comprising NINETEEN Double Quarto Pages, (of Five Columns Each Finely Illustrated, and Neatly Printed on Book Paper A Title Page, Index, &c., at close of each Volume.

Only \$3 a Year; in clubs of ten or more \$2.50. Now is the Time to Form Clubs! Very liberal inducements to Local Clo Agents—including Over One Hundred Valuable Pre- miums, ranging in price from 25 to \$200! Specimen- Premium Lists, Show Bills, &c., sent free. Drafts, Or- ders, &c., at our risk.

Address **D. D. T. MOORE,**  
41 PARK ROW, New York.

Kate, Abbie, Carrie and Sarah. About 1851 George and his family removed to Racine, Wis., where he remained until his death probably about 1868. What was the maiden name and lineage of his wife Laura or Laurina? As she named her only son Henry Parker possibly Parker might have been her family name.

Theodore Irish, a relative, thought to be an uncle or cousin of Henry she was near

NY St. Lib.

... Walker of Windsor, Conn. Her ancestry desired.  
A. PORTER. Information desired concerning Thomas Porter of Farmington, Conn. A daughter Sarah married Nathaniel (2) Winchell. C. F. L.

(753) PEARL. Can anyone tell me if

"ancestry" at Sherborn seems most probable, and I thank you for stating it. W. W. N. Y.

165. 3. RUDE, PARK. A. B. H. April 2, 1923. I very much regret that I cannot supply the data called for as to the John Park, with a daughter Lucy married November, 1756, to Elijah Witter.

6/19/94

Sutton

Boston Transcript 28 May 1923, 29

and was he a descendant of the Bass family of Massachusetts? He was born about 1795-1800, where I have no knowledge, but suppose in Kentucky or Tennessee. He married, in Georgia, about 1825, Anna Dossia. He lived near Atlanta and was a slave owner and cotton planter on a large scale. They had five children, who were: Jane, married Marshal Davey; Cynthia, married John Arnold; Jephtha, who was a doctor and served as a surgeon during the Civil War; Thomas, who served in the Civil War and died of fever in the service; Emily, married James T. Prosser. The family moved to Alabama while a portion of the children were young. They lived near Eufaula, where Buckner Bass died about 1859. B. M. N.

(784.) 1. TIDD, SIMONS. Who were parents of Mary Tidd who married Joseph Simons of Woburn about 1875? Who was Rachael, wife of Joseph Simons of Lexington married about 1710-1715?

2. DAVIS, SIMONS. Who were parents of Mary Davis who married Col. Benjamin Simons about 1755?

3. OSBORN, BENNETT. Who were parents of Sarah Bennett, who married John Osborn of Fairfield, Conn., about 1875?

4. WOOD. Who was Margaret, wife of William Wood of Concord, Mass.? She died there Sept. 1, 1659. Who was Sarah, wife of Abram Wood of Concord, Mass.? They were married in 1682.

5. COLE, BRYANT. Who were the parents of Joanna Cole, who married Deacon Samuel Bryant, probably of Scituate, about 1695? Joanna was born 1672, died Dec. 18, 1736.

6. EDWARDS, SAMS. John Edwards and Mary Sams were married probably at Ipswich, about 1660. Will someone give me the names of the parents of both John and Mary?

7. BOSWORTH. Hannah, the ninth child of Jonathan (2) Bosworth, was born 1650, married, Nov. 25, 1667, whom? Who was Susanna, mother of Hannah?

8. JACKSON. Who were the wives of Henry (1) Jackson of Fairfield, Conn., the emigrant, and John (2) Jackson of Jackson Mills, Bridgeport, Conn., who were living between 1640 and 1700?

9. DARLING, HISHOP. Who were the parents of John Darling of Braintree and of Mary Bishop who were married 1650-1670?

10. DABY. Who was Mary, wife of Thomas (1) Daby of Concord, Stow and Harvard, 1680 to 1738, and who was Hannah, wife of John (2) Daby, born at Stow 1687, died at Harvard 1769?

11. ROGERS, WILLIAMS. Anna Rogers, daughter of John (2) Rogers (Thomas 1), married for her third husband Samuel Williams. Her sister, Elizabeth Rogers, married Nathaniel Williams. Will someone give me the names of the children of these marriages, with names of their husbands

Richard More of Mayflower line married, for first wife, Christian Hunt. She died at Salem, 1676. By her he had a daughter Susanna, who married Captain Samuel Dutch of Salem. This man Dutch was dead by March, 1693-4. His widow married before Dec. 13, 1694, Richard Hutton of Wenham. He was at that time appointed guardian of her daughter Susanna Dutch, aged about 12. Was this Susanna Dutch born about 1682, the one who married Benjamin Knowlton, 1765? Was Samuel Dutch, her father, an unrecorded son of Osmond (1) Dutch? G. O. F. C.

29. SUTTON. P. N. M., Aug. 28, 1922. Even though so long a time has elapsed since the time of this query, I hope this will be seen by P. N. M., who asked about Rev. James Sutton and his four sons of Pennsylvania, all of whom served in the Revolution, or by someone else who is interested in Sutton lines. Moses Sutton, born about 1745, was supposed to have been born either in Fairfax county, Va., or in New Jersey. He served in the Revolution, though I have been unable to find documentary proof of service, but according to family accounts he was at one time a member of Washington's Life Guard. I have no record of his ancestry or near relatives, so know nothing of Rev. James, but as Moses lived in Pennsylvania as well as New Jersey and Virginia, it is more than possible that they were related. Moses married Susannah Cox, a native of New Jersey, and their children were: Philip, born 1770; Isaac; Moses, and Levi, born July 25, 1789; possibly others. Moses Sr.'s ancestors (according to family tradition) lived on the site of Newark, N. J., and owned land there which was to be divided "in the fifth generation." There was some action taken by his descendants, but the title had lapsed, so nothing came of it. Any information regarding these will be greatly appreciated. DOWAGIAC

165. 2. MEARS. E. G. D. C., Feb. 12, 1923. As you say you are more interested in Robert of Billerica and Tewksbury, I thought it might be of interest to you to have the small amount of data which I have concerning him, and his descendants, and incidentally it might be of interest also to others. Robert Mears died in Tewksbury, Mass., July 3, 1784, aged 80 years, according to the Congregational Church records of that town. This would give him an approximate birth date of about 1695, if his age as given is correct. Of course gravestone records can not be greatly relied on, but so far as I know, there has been no record found proving any error in this one, so until one is found, we must accept it, I suppose. Robert (1) Mears is supposed by Hazen to be a son of Robert of Boston. As Robert (1) Mears of Boston died between June 20

Adams, but whether he was the one born in 1671 or in 1676, supposing these to be two different persons, of which we are by no means certain, it would be possible for him to have been the father of Robert (1) of Billerica, providing he had a first wife, and if Robert, born 1676, was the husband of Elizabeth, and was a different man from the Robert, born 1671, then the latter could easily have settled in a town to the west, and have been the father of Robert (1) of Billerica. Of the eleven children of James (2), (Robert 1) of Boston, only three are accounted for, those having died more or less young, the other eight are lost sight of, and neither wills or deeds, commissioners' records or vital records account for them to an extent that would prove their residence in Boston. However, the Robert Mears who had a wife Elizabeth is accounted for in Boston on July 20, 1732, as a "retaylor out of doors" and Elizabeth Miers applied for a similar license about Aug. 1, 1734, which would seem to indicate that the death records of these two people as given in the Copp's Hill records are correct, at least. If all dates and ages are correct, which they probably are not, this would give us one Robert of Boston, and possibly two, who could be the father of Robert (1) of Billerica, so I do not think that it is by any means proven that Hazen is wrong in his supposition, although there are no records so far found in proof of the theory.

Robert (1) Mears married, first, in Billerica, Mass., April 21, 1726, Hannah Frost, born May 13, 1702, in Billerica, died Sept. 22, 1756, in Tewksbury, Mass., the daughter of Samuel and Hannah (—) Frost, who resided in Billerica. Children born to this couple in Billerica were: Abigail (2), born Jan. 17, 1726-7, married Jonathan Dutton; Hannah, born April 21, 1728, married Benjamin Dows; Mehitabel, born Dec. 11, 1729, married Gload Longun; Mary, born July 24, 1731, married Richard Thisel; Roger, born March 16, 1732-3, married, first, Mrs. Dorcas (Sprake) Levistone, married, second, Judith Daverson; Lettice, born March 13, 1734-5; Samuel (2), born Aug. 18, 1736, married Rebecca Brown; and in Tewksbury children born to this couple were: Thomas, born April 24, 1738, married Lydia Carleton; John, born April 3, 1741, married Jane Stickney; Daniel, born March 3, 1743, married, first, Mary (Hannah) Leathe, married, second, Elizabeth Mower. Robert (1) Mears married, second, in Tewksbury, Mass., Feb. 17, 1757, Sarah Bean, who died in Tewksbury, Feb. 12, 1761, of smallpox. Children born to Robert (1) and Sarah were: William, born Dec. 15, 1757, died Feb. 16, 1761, of smallpox; and Joseph, born May 18, 1759, died Feb. 18, 1761, of smallpox. Robert (1) Mears married, third, in Lexington, Mass., Aug. 30, 1763, Rebeckah Bathrick, in one record called "Mathrick." I believe the name Bathrick to be correct. She died Oct. 12, 1793, in Tewksbury, Mass., "supposed to be the parents of these or possibly four

**HENRY STODDARD, RomE.**

Whitman Stoddard was born in Litchfield, Connecticut, about the year 1812, was taken prisoner by in close confinement at Halifax during one winter. turned to Litchfield, where he married Rhoda Ben- by whom he had two children. She died in Shel- N. Y., in 1820. Mr. Stoddard then married and in 1834 moved to Rome Township, Lenawee ed wife he had six children, the eldest of whom of this record, he being born in Sheldon, Wyo- February 22, 1822. From New York the subject to Michigan with his parents, with whom he lived years of age. His father died July 7, 1837. On 4, Mr. Stoddard married Caroline F. Young. A sessed this union; but the son, named after his owned at Round Lake, in Rollin, on the 19th of dard lived on his farm in Rome Township until A. P. Kimball and two other companions he took 'nishing his business there, he, with his compan- taking passage on the steamer "Emma No. 3;" ed to never reach his earthly home, the steamer 35, in the Mississippi River, on the 19th of Feb- of one hundred persons suffered death through hom were Mr. Stoddard and two of his compan- ing himself by swimming, but reached the banks great exertion.

**A. P. KIMBALL**

1841, in Lenawee County, Michigan. He lived her until he was nineteen years of age, when at the Rebellion he enlisted as a private for the three r Captain W. H. Graves, in Company K, 1st le took part with his regiment in the first move- oops around Washington, and participated in the On the 9th of August, 1861, he was discharged from 9th of the following September he re-enlisted in ry, under Captain Latimer. From Grand Rapids, as organized, he went with it to St. Louis, Mo., winter quarters in "Benton Barracks." From took part in all the battles in which his regiment luded the battles of New Madrid, Pittsburg Land- s, Corinth, Wyatt's Landing, Jackson (Tenn.), oolia, and many others. Mr. Kimball entered the t by promotion became second lieutenant of Com- t. On the 11th of June, 1865, he was discharged on Rouge, La., and returned home, where, in the r, he married Miss Cornelia M. Stoddard, only dard; the fruits of this union have been two chil- born May 8, 1868, and Eda Hell, born June 13, d family own two hundred and forty-five acres of fine state of improvement, and which is considered d farms in Rome Township. Mr. Kimball has interest in all matters pertaining to the public wel- ituzism, honorable man, and enterprising farmer, l.

**AVID SMITH, JR., RomE.**

In New York, and moved to Rome Township, 32. In 1833 he entered one hundred and twenty nd, which he commenced to clear and get ready rm has been his home to the present time. In meline Hawley, of Rome Township, and has since ally of six children. Mr. S. was elected school off the first school district in the townships of ing a fractional district. He has also held var- ious trusts. He now owns a farm of one hundred tered, and upon which are many of the modern arranged farm. Mr. Smith is looked upon by his ood citizen and an honorable man, and as such

**MES K. JEFFERY, RomE,**

County of Kent, England, in 1803. For several attended school in his native place; he also at- in France. March 8, 1826, he married Harriet in Dover, England, August 11, 1800. In 1830, lled for America, where he settled in Oneida here he lived until 1836, when he emigrated to see County, Michigan, where he purchased land e. In 1837 he lost his house and his household t Mr. Jeffery purchased the land upon which he ne. In 1852 he started with a company for an lifornia, with a son and two daughters. His son s buried on the plains. After almost incredible ed California, where Mr. J. remained but a short to Lenawee County. In 1864 he again suffered nearly all its contents by fire. Mr. Jeffery's farm dred and twenty acres, nearly all of which are rovement. Mr. Jeffery came to Rome when the ways taken an active part in everything pertain- s township, and enjoys the respect and esteem of

**C. L. BLANCHARD, MEDINA,**

was born June 27, 1836, in Oakland County, Michigan. Being left with- out a father while young, he, at the age of thirteen, came to Medina Township, in Lenawee County, where he lived with an uncle until he was twenty-one years of age. On attaining his majority he purchased a farm

on Section 35, in the township mentioned, where he lived until 1863, when he purchased the farm where he now resides. On the 10th of April, 1856, Mr. Blanchard married Miss Clarissa O. Baldwin, of Me- dina, and the result of this union has been a family of eight children, viz.: Lura E., born February 7, 1856; Charles E., born March 26, 1858; Ernest W., born November 2, 1860; Cyrus M., born March 3, 1862; Willard A., born December 2, 1864; Ethel N., born October 17, 1866; Walter M., born July 30, 1869; and Edith E., born October 19, 1872. All of the above children are now living, with the exception of Ernest W. and Ethel N. Mr. Blanchard's farm consists of two hundred and eighty acres of land, and such is the high state of cultivation and im- provement to which he has brought it, that it has more the appearance of being a well-kept garden than a large farm. An illustration of Mr. B.'s farm may be seen elsewhere in this work. For several years he has given much attention to raising fine blooded stock, and the result is that some of his cattle cannot be surpassed in the County, if in the State. Among his Durhams may be mentioned the "Duke of Hillsdale." The fine residence, long rows of shade-trees, well-kept fences, the pleasant surroundings, all form a home that cannot be described by the pen, but which point out Mr. Blanchard as a man of energy and enterprise.

**SUPFRENUS DEWEY, MEDINA,**

the subject of this biography, was born in Scholastic County, New York, May 14, 1797. While young he was bound out to a man living in Augustus, Oneida County, with whom he lived two years; at the end of that time he was again bound out to a man by the name of Rice, with whom he lived until 1818, when he left him and went to Leroy, New York, where he worked at the carpenter's trade. In 1824 he married Diana Stevenson, of Leroy, and continued to work at the carpenter's trade until 1832, at which time he went to Brockport, New York. In the fall of 1834 he moved with his family to Lenawee County, and bought land, which he settled upon and cleared. Here Mr. Dewey fol- lowed farming until 1846, when, leaving his family comfortably pro- vided for, he went to Wisconsin and worked at his trade. While he was absent death was busy at work among his loved ones at home, and he lost three of his children. In 1860 he returned to Michigan with his wife, she having joined her husband in Wisconsin after the death of her children. In April, 1863, death again crossed Mr. Dewey's threshold and claimed his wife for a victim. In 1865 he married again.

Among the many buildings Mr. Dewey has erected, while working at his trade, may be mentioned the Masonic Temple, in Genesee County, New York, and the Globe Mills, at Tecumseh, Michigan. As an honored and respected citizen Mr. Dewey enjoys the confidence in the highest degree of the community in which he resides.

**WILLIAM SUTTON, MEDINA,**

was born in the township of Junius, Seneca County, New York, on the 21 day of May, 1808. The grandfather of the above-named gentleman was a soldier during the Revolutionary War, having enlisted when but sixteen years of age. He took part in nearly all of the many promi- nent battles which took place during the war for our independence in the States of New Jersey and the Carolinas. He received seven severe sword- wounds, but lived to tell in after-years of the battles fought and won by the patriots of 1776. He died at his home in Seneca County, N. Y., in 1825. His wife moved subsequently to Wayne County, where she died in 1837. The subject of our biography lived in Seneca County until he was about sixteen years of age, at which time he went to Lyons, Wayne County, N. Y., and learned the carpenter's trade. On the 16th of June, 1829, he married Miss Rebecca Burnett, of Ontario County, N. Y. Mr. Sutton resided in Lyons until the spring of 1835, when, with his wife and three children, he started for Michigan. Arriving at Toledo, by way of the lakes, in the fall of 1835, he started with his family through the then almost unbroken wilderness, and after a tedious journey of weeks, he arrived at the spot where Morenci now stands. Here he lived for about two years, and then purchased land in the township of Gorham, Fulton County, Ohio. He lived on this farm (which he still owns) until about three years since, when he moved to his present place of residence in Medina Township, where he owns one hundred and twenty acres of land. Mr. Sutton owns the two farms above mentioned, which aggregate four hundred and sixty acres. Over three hundred acres of this land are under a fair state of cultivation, the remainder consisting of timber- and grazing-land. Mr. Sutton and wife have reared a family of fourteen children, viz., George B., Henry H., Julia Ann, Andrew J., James M., Sarah J., Robert B., Harvey, Mary L., Charles A., William W., Helen L., Oliver C., and Frank,—all of whom are now living with the exception of Henry, Oliver, and Helen. Mr. Sutton has lived an active, en- ergetic life; he has lived to see the former forest-covered country give way to man's industry, and become settled by thousands of prosperous citizens.

**E. A. MILLIKEN, MEDINA,**

was born on the 13th of June, 1813, in Dublin, New Hampshire. His parents moved to Keena, N. H., when he was three years of age. In 1836 he married Miss Susan E. Town, also of Keena. In 1838 Mr. Milliken and wife moved to Clarendon, Orleans County, N. Y., where they were blessed with three children,—Susan E., born March 11, 1839; E. A. Milliken, Jr., born December 14, 1840; and Emily E., born April 27, 1842. The mother of these children died October 14, 1842. Her infant daughter, Emily, died on the 16th of the same month, and, folded in the arms of her mother, they were committed to the same grave. March 3, 1847, at Wells River, Vt., Mr. Milliken married Miss Christiana Laing, his present wife. They continued to live in Orleans County, where their son, Robert L., was born, April 21, 1848. In the fall of 1853 he moved with his family to Hudson Township, in Lenawee County, and where, on the 18th of March, 1857, James D. Milliken was born. Here the subject of our sketch lived until the spring of 1869, when he moved to his present place of residence in Medina Village, where he is at the present time engaged in keeping a hotel. Mr. Milliken is a genial, kind-hearted man, who has a large circle of friends and acquaintances.

5-25-94  
Combined Notes of Lenawee Co, MI 1874, 1893, 1916  
It looks like someone copied together was then family - or else this is  
PERSONAL SKETCHES. Nothing fits our family.  
Lenawee Co Lib  
234

Something wrong here!?!  
E. A. MILLIKEN, MEDINA,

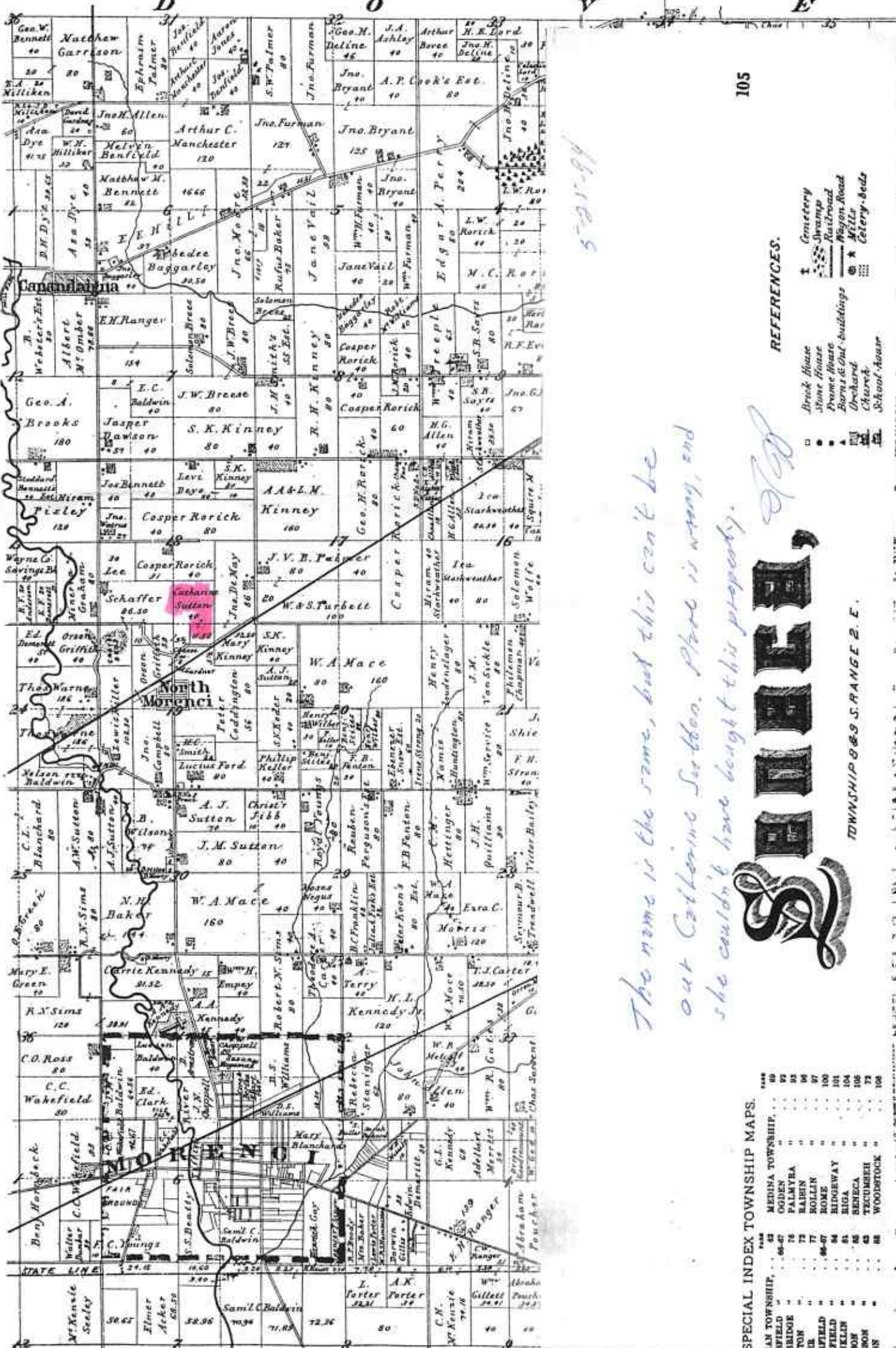

*The name is the same, but this can't be our Catherine Sutton. There is wrong, and she couldn't have bought this property.*

REFERENCES.

- Brick House
- Stone House
- Prone House
- Barns & Out-buildings
- Overland
- Cherch
- School-house
- Cemetery
- Swamp
- Railroad
- Wagon Road
- Mill
- Cemetery-beds

# SUTTON

TOWNSHIP 8 & 9 S. RANGE 2. E.

SPECIAL INDEX TOWNSHIP MAPS.

NAME	PAGE
LAN TOWNSHIP	48
WELLS	50
BRIDGE	56-57
FOUR	75
EL	77
FIELD	86-87
FIELD	100
SKILL	101
SON	104
SPON	105
OS	106
MEDINA TOWNSHIP	50
OGDEN	93
PALMYRA	93
RABIN	96
ROLLIN	97
ROME	97
RIDGEWAY	100
BIGA	101
SENECA	104
TECUMSEH	105
WOODSTOCK	106

GENERAL INDEX TO NAMES OF LAND-OWNERS OF LENAWEE COUNTY, AS PER ASSESSMENT OF 1892.

Main table with columns: NAME, Post Office, Section, Acres, NAME, Post Office, Section, Acres, NAME, Post Office, Section, Acres. Lists names and land details for Seneca and Rome counties.

ROME.

Continuation of the main table, specifically listing land owners in Rome.

Revd 7-31-88  
Branch Co. Clerk

MAY'S OLDEST SISTER

STATE OF MICHIGAN

COUNTY OF BRANCH

MARRIAGES

<u>No.</u>	<u>Date of Marriage</u> <u>Mo. Day Year</u>	<u>Full Name and Color</u> <u>of Bridegroom and Bride</u>	<u>Residence of each</u> <u>at time of marriage</u>	<u>Age of each</u> <u>in years</u>	<u>Birthplace</u> <u>of each</u>	<u>Occupation of</u> <u>bridegroom</u>
679	Jan 1 1870	Ezeriah J. Parmelee (w) Lydia Ann Sutton (w)	Hudson, Lenawee Co. Michigan	38	Volney, Oswego County, N. Y.	Carpenter
	<u>Place of</u> <u>marriage</u>		Coldwater, Branch County, Michigan	18	Coldwater, Mi.	--
	Coldwater, Mich.					

<u>Name of official station of</u> <u>person by whom married</u>	<u>Witnesses to</u> <u>marriage.</u>	<u>Residences</u>	<u>Date of record</u>
A. W. Curtis, Minister of the Gospel, Coldwater	Catharine Banker Marilla Clapp	Coldwater, Michigan Coldwater, Michigan	January 6, 1870

*Catherine (Warren) Sutton Banker*

Rev'd 7-31-88  
Branch & Clerk

STATE OF MICHIGAN

COUNTY OF BRANCH

MARRIAGES

<u>No.</u>	<u>Date of Marriage</u> <u>Mo. Day Year</u>	<u>Full Name and Color</u> <u>of Bridegroom and Bride</u>	<u>Residence of each</u> <u>at time of marriage</u>	<u>Age of each</u> <u>in years</u>	<u>Birthplace</u> <u>of each</u>	<u>Occupation of</u> <u>bridegroom</u>
1964	Oct 28 1874	George Warren (w) May Sutton (w)	Union, Michigan Union, Michigan	19 16	Jonesville Allen	Farmer
	<u>Place of marriage</u> Coldwater					

<u>Name of official station of</u> <u>person by whom married</u>	<u>Witnesses to</u> <u>marriage</u>	<u>Residences</u>	<u>Date of record</u>
David B. Purington, Justice of Peace	Grace Warren Alfred Thompson	Union, Michigan Coldwater, Michigan	Oct. 28, 1874

Card 7-31-88  
Branch Co. Clerk

Wrong Mary Warren

STATE OF MICHIGAN

COUNTY OF BRANCH

RECORD OF DEATHS

<u>No.</u>	<u>Date of Death</u>			<u>Full Name of the Deceased</u>	<u>Sex &amp; Color</u>	<u>Married, Single or Widowed</u>	<u>Age</u>			<u>Place of Death</u>	<u>Disease or Cause of Death</u>
	<u>Mo.</u>	<u>Day</u>	<u>Yr.</u>				<u>Yrs.</u>	<u>Mo.</u>	<u>Days</u>		
172	Jan	9	1886	MARY WARREN	F	Widow	70	-	-	4th Ward- City	Dropsy

<u>Birthplace</u>	<u>Occupation</u>	<u>Parents</u>	<u>Residences</u>	<u>Date of Record</u>
Ireland	Housekeeper	<u>Names</u> Dead Dead		June 12, 1887

Mr. Porter: This is typed exactly as  
it was listed in the oldest death ledger A  
page 234



Eli Banker  
and  
Catharine Sutton

State of Michigan  
County of Hillsdale } This may certify, that Eli  
Banker of the Township of Hills-  
dale, County of Hillsdale, State of Michigan aged 42  
years, and Catharine Sutton of the Township of Hills-  
dale, County of Hillsdale, State of Michigan aged 52  
years, were joined together in Holy Matrimony by me,  
at Hillsdale Township this Seventh day of November  
1861.

In presence of  
Lydia Fox  
Matilda Fox

G. W. Warren  
Justice of the Peace.

Recorded Nov. 29. 1862

STATE OF MICHIGAN. }

COUNTY OF HILLSDALE } ss.

I, THOMAS C. MOHR

Clerk of said County and Clerk of the Circuit Court for said County, the same being a Court of Record, having a seal do hereby certify that the above is a true copy of the Record of Marriage of

ELI BANKER and CATHARINE SUTTON

now remaining in my office, and of the whole thereof.

In Testimony Whereof, I have hereunto set my hand and affixed the seal of

(L. S.) the Circuit Court the 23rd day of August, A. D. 1990

Thomas C. Mohr Clerk.

By Conat Lou Williams Deputy Clerk.

NOTE 1. Insert "Deputy" when desired.

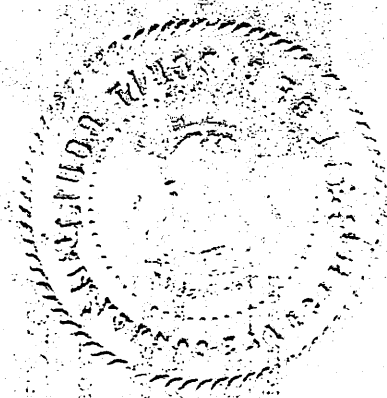

(5)

*Handwritten signature and address in the bottom right corner.*

*Faint, mostly illegible handwritten text covering the majority of the page, possibly representing a letter or a list of items.*

STATE OF OHIO  
BUREAU OF VITAL STATISTICS  
CERTIFICATE OF DEATH

PLACE OF DEATH

County of Henry  
Township of \_\_\_\_\_ Registration District No. 277 File No. 8921  
or \_\_\_\_\_  
Village of Liberty Cent Primary Registration District No. 2288 Registered No. 7  
or \_\_\_\_\_  
City of \_\_\_\_\_ (No. \_\_\_\_\_ St. \_\_\_\_\_ Ward \_\_\_\_\_)

(If death occurs away from UNUSUAL RESIDENCE give facts called for under "Special Information.")

FULL NAME Catherine Sutton

(If death occurred in a hospital or institution, give the NAME (instead of street and number.)

PERSONAL AND STATISTICAL PARTICULARS

SEX Female COLOR OR RACE White  
DATE OF BIRTH Nov 30 1829  
(Month) (Day) (Year)

AGE 80 years, 2 months, 18 days.

SINGLE, MARRIED, WIDOWED, OR DIVORCED

BIRTHPLACE (State or Foreign Country) Ohio

OCCUPATION Horse Keeping

NAME OF FATHER Daniel Waring

BIRTHPLACE OF FATHER (State or Foreign Country) Ohio

MAIDEN NAME OF MOTHER Not known

BIRTHPLACE OF MOTHER (State or Foreign Country) Not known

THE ABOVE STATED PERSONAL PARTICULARS ARE TRUE TO THE BEST OF MY KNOWLEDGE AND BELIEF

(Informant) Miss Mary Linton  
(Address) Madisonville

Filed Feb 19 1910  
R.A. Bullock  
Registrar

MEDICAL CERTIFICATE OF DEATH

DATE OF DEATH Feb 18 1910  
(Month) (Day) (Year)

I HEREBY CERTIFY, That I attended deceased from James 1910 to Feb 17 1910 that I last saw her alive on Feb 17 1910 and that death occurred, on the date stated above, at 9 A.M.

M. The CAUSE OF DEATH was as follows:

Apoplexy

(Duration) \_\_\_\_\_ Days  
Contributory Arteriosclerosis of heart

(Signed) J. P. Huey M.D.  
Feb 18 1910 (Address) Liberty Cent, O.

or SPECIAL INFORMATION only for Hospital, Institution, Tru-  
sents, or Board Residents.

Former or (How long at) \_\_\_\_\_  
Usual Residence (Place of Death?) \_\_\_\_\_ Days

Where was disease contracted, if not at place of death?

PLACE OF BURIAL, or REMOVAL Indian Mchman DATE OF BURIAL Feb 21 1910

UNDERTAKER George Fester ADDRESS Liberty Cent

N.B.—Every item of information should be carefully supplied. AGE should be stated EXACTLY. PHYSICIANS should state CAUSE OF DEATH in plain terms, that it may be properly classified. The "Special Information" for persons died away from home should be given in every instance.

*Clend 7-27-90 from DeKalb Co. Clerk*

MARCH TERM, 1903.

26th. Day.

Tuesday March 31st., 1903.

6831. May Porter )  
-vs- )

) DIVORCE.

Clarence Porter ) Comes now the plaintiff in person and by George W. Crooks, her Attorney,  
and the court finds that the defendant has been duly served with process  
herein ten days prior hereto and to the return day of the writ as appears from the summons  
issued herein and the Sheriff's endorsement thereon in these words, ( h i ). Upon motion the  
defendant is three times called in open court and comes not but wholly makes default.

Upon plaintiff's motion this cause is submitted to the court for trial and after hearing  
the evidence and being sufficiently advised in the premises, the residence of the plaintiff  
being proven by the testimony of George W. Crooks and Fredrick C. Waterman, resident house-  
holders and free-holders in DeKalb County, Indiana, the Court finds for the plaintiff upon  
her complaint that the material allegations therein contained are true and proven, that the plaintiff  
is the wife of the defendant and that she is entitled to a divorce from him as prayed.

It is therefore ordered, adjudged and decreed by the Court that the plaintiff May Porter be di-  
vorced from the defendant Clarence Porter, that the marriage contract and relation heretofore enter-  
ed into by and between said parties be set aside, annulled and dissolved and that said parties be  
and remain toward each other as though such contract and relation had never existed. It is further  
ordered by the court that the defendant pay the costs of this action herein made.

COURT IS NOW ADJOURNED UNTIL TOMORROW MORNING AT 8:30 O'CLOCK. PUBLICLY READ AND SIGNED IN OPEN  
COURT.

*Mark M. Towan* Special Judge.

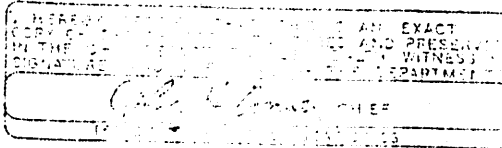

011871

JUN 13 1928

STATE OF OHIO  
DEPARTMENT OF HEALTH  
DIVISION OF VITAL STATISTICS  
CERTIFICATE OF DEATH

1 PLACE OF DEATH  
County Lucas Registration District No. 769 File No. 31951  
Township \_\_\_\_\_ Primary Registration District No. 8349 Registered No. 153  
or Village \_\_\_\_\_ No. \_\_\_\_\_ St. \_\_\_\_\_ Ward \_\_\_\_\_  
or City of Wesley (If death occurred in a hospital or institution, give its NAME instead of street and number)

2 FULL NAME May L. Linton Did Deceased Serve in U. S. Navy or Army \_\_\_\_\_  
(a) Residence. No. 944 Curtis St. \_\_\_\_\_ Ward \_\_\_\_\_  
(Usual place of abode)  
Length of residence in city or town where death occurred yrs. mos. ds. How long in U. S., if of foreign birth? yrs. mos. ds. (If nonresident give city or town and State)

PERSONAL AND STATISTICAL PARTICULARS				MEDICAL CERTIFICATE OF DEATH	
3 SEX <u>Female</u>	4 COLOR OR RACE <u>White</u>	5 Single, Married, Widowed or Divorced (write the word) <u>Widow</u>		16 DATE OF DEATH (month, day and year) <u>May 8 1928</u>	
5a If married, widowed or divorced HUSBAND of (or) WIFE of <u>Samuel Linton</u>				17 I HEREBY CERTIFY, That I attended deceased from <u>June 1, 1927</u> , to <u>May 8, 1928</u>	
6 DATE OF BIRTH (month, day, and year) <u>Jan 11 1859</u>				that I last saw <u>her</u> alive on <u>May 8, 1928</u>	
7 AGE Years <u>69</u>	Months <u>3</u>	Days <u>28</u>	If LESS than 1 day _____ hrs. or _____ min.	and that death occurred, on the date stated above, at <u>4.0 P. m.</u>	
8 OCCUPATION OF DECEASED (a) Trade, profession, or particular kind of work <u>At Home</u>				The CAUSE OF DEATH* was as follows: <u>Obstruction of the bowel</u> <u>Probable due to carcinoma</u> <u>of the liver</u>	
(b) General nature of Industry, business, or establishment in which employed (or employer)				(duration) _____ yrs. _____ mos. <u>3</u> ds.	
(c) Name of employer				CONTRIBUTORY (SECONDARY)* <u>Dropsy Probable</u> <u>due to carcinoma</u> (duration) <u>1</u> yrs. <u>2</u> mos. <u>10</u> ds.	
9 BIRTHPLACE (city or town) <u>Goldwater</u> (State or country) <u>Mich</u>				18 Where was disease contracted if not at place of death? _____	
PARENTS	10 NAME OF FATHER <u>Lewis Sutton</u>			Did an operation precede death? <u>no</u> Date of _____	
	11 BIRTHPLACE OF FATHER (State or country) <u>Mich</u>			Was there an autopsy? <u>no</u>	
	12 MAIDEN NAME OF MOTHER <u>Leathernis Warren</u>			What test confirmed diagnosis? <u>Examination</u>	
	13 BIRTHPLACE OF MOTHER (city or town) (State or country) <u>Ohio</u>			(Signed) <u>J. L. Green</u> M. D. <u>May 2nd</u> , 1928 (Address) <u>316 N. Jackson St</u>	
14 Informant <u>Mae L. Kezney</u> (Address) <u>944 Curtis St.</u>				19 PLACE OF Burial, Cremation, or Removal <u>Waterloo Ind</u> DATE OF BURIAL <u>May 10-28</u>	
15 Filed <u>5/19</u> 1928 <u>Wm. J. Miller</u> REGISTRAR				20 UNDERTAKER <u>Walter Am</u> ADDRESS <u>Shledo</u>	
				20a EMBALMER <u>H. H. Greenwald</u> LICENSE No. <u>7467-A</u>	

**The State of Ohio, Cuyahoga County, ss.**

*Elihu S. ...*

**TO**

*Mary Kelley*

*I hereby certify, that on the 1<sup>st</sup> day of July, A. D. 1847, I duly solemnized the Marriage Contract between the said Elihu S. ... and Mary Kelley*

*Austin Kelly Justice of the Peace*

**The State of Ohio, Cuyahoga County, ss.**

*Levi W. Sutton*

**TO**

*Catharine Warren*

*I hereby certify, that on the 30<sup>th</sup> day of June, A. D. 1847, I duly solemnized the Marriage Contract between the said Levi W. Sutton and Catharine Warren.*

*Austin Kelly Justice of the Peace*

**The State of Ohio, Cuyahoga County, ss.**

*Hervey S. Johnson*

**TO**

*Lucas Braughton*

*I hereby certify, that on the 1<sup>st</sup> day of August, A. D. 1847, I duly solemnized the Marriage Contract between the said Hervey S. Johnson and Lucas Braughton.*

*D. H. Fisher Justice of the Peace*

**The State of Ohio, Cuyahoga County, ss.**

*Captain William Sisson*

**TO**

*William Sisson*

*I hereby certify, that on the 23<sup>rd</sup> day of July, A. D. 1847, I duly solemnized the Marriage Contract between the said Captain William Sisson and William Sisson.*

*H. S. Parrish Minister Gospel*

Copied 7-26-88 at FHC, Orange Stake Calif.

Probate Office Cuyahoga Co. Courthouse 5624 Ohio

Marriage Records Vol 4 1838-1849, p. 403

GS Film No. 877913 (M514232)

**The State of Ohio, Cuyahoga County, ss.**

*Elliott & Co*

**TO**

*Mary Kelly*

*I hereby certify, that on the 10<sup>th</sup> day of July,  
A. D. 1847, I duly solemnized the Marriage Contract  
between the said Elliott & Co and Mary  
Kelly*

*Justin Selby,  
Justice of the Peace.*

**The State of Ohio, Cuyahoga County, ss.**

*Levi W. Sweeney*

**TO**

*Catharine Warren*

*I hereby certify, that on the 30<sup>th</sup> day of June,  
A. D. 1847, I duly solemnized the Marriage Contract  
between the said Levi W. Sweeney and Catharine  
Warren.*

*Justin Selby,  
Justice of the Peace.*

**The State of Ohio, Cuyahoga County, ss.**

*Hervey S. Johnson*

**TO**

*Lucius Braughton*

*I hereby certify, that on the 1<sup>st</sup> day of August,  
A. D. 1847, I duly solemnized the Marriage Contract  
between the said Hervey S. Johnson and Lucius  
Braughton.*

*D. W. Fisher,  
Justice of the Peace.*

**The State of Ohio, Cuyahoga County, ss.**

*Captain William Sweeney*

**TO**

*Melinda Allen*

*I hereby certify, that on the 25<sup>th</sup> day of July,  
A. D. 1847, I duly solemnized the Marriage Contract  
between the said Captain William Sweeney and Melinda  
Allen.*

*H. S. Perriest,  
Justice of the Peace.*



Copied 7-26-58 at FHC, Orange State Calif  
Probate Office Cuyahoga Co. Courthouse State Ohio  
Marriage Records, Vol 4. 1838-1849, p. 402

GS Film 877913 (14514232)

10-2-58

in the age of eighteen years, that she has no husband living and that the parties are not nearer of kin than first cousins, as he verily believes.

Subscribed and sworn to the 24<sup>th</sup> day of June 1847 Before me, *Wm Clark Dep* CLERK.

*Wm Clark* Notary Public

The State of Ohio, }  
CUYAHOGA COUNTY, ss.

*Levi W. Sutton* to state of T

having made application for a Marriage License for *himself* and *Catharine Warren* of said County, and being duly sworn, on his oath, says that *she* is of the age of *twenty-one* years, that he has no wife living, that she is of the age of *eighteen* years, that she has no husband living and that the parties are not nearer of kin than first cousins as he verily believes.

Subscribed and sworn to the 25<sup>th</sup> day of June 1847 Before me, *Wm Clark Dep* CLERK.

I consent to the above being the father of the said *Catharine* June 25. 1847.

The State of Ohio, }  
CUYAHOGA COUNTY, ss.

*Jacob Switzer* to state of T

having made application for a Marriage License for *himself* and *Elizabeth Switzer* of said County, and being duly sworn, on his oath, says that *she* is of the age of *twenty-one* years, that he has no wife living, that she is of the age of *eighteen* years, that she has no husband living and that the parties are not nearer of kin than first cousins as he verily believes.

1847 June 24 & 25 Dep. Wm Clark's Application 1847-51

Filed Oct 7 2 46 PM Cuyahoga Co. OH Marriage App. Book No. 149-51

is of the age of eighteen years, that she has no husband living and that the parties are not nearer of kin than first cousins, as he verily believes.

Subscribed and sworn to the 24<sup>th</sup> day of June 1847 Before me,

*A. Clark Dep* CLERK.

*March 24 1847*

The State of Ohio, }  
CUYAHOGA COUNTY, ss.

*Levi M. Sutherland* of the State of Ohio

having made application for a Marriage License for ~~himself~~ *and Catharine* of said County, and being duly sworn, on his oath, says that ~~she is~~ *she is* of the age of twenty-one years, that he has no wife living, that she is of the age of ~~eighteen~~ *eighteen* years, that she has no husband living and that the parties are not nearer of kin than first cousins, as he verily believes.

Subscribed and sworn to the 25<sup>th</sup> day of June 1847 Before me,

*A. Clark Dep* CLERK.

I consent to the ~~same~~ *same* of the said ~~Catharine~~ *Catharine* June 25. 1847.

The State of Ohio, }  
CUYAHOGA COUNTY, ss.

*Jacob* of the State of Ohio

having made application for a Marriage License for ~~himself~~ *and* of said County, and being duly sworn, on his oath, says that ~~she is~~ *she is* of the age of twenty-one years, that he has no wife living, that she is of the age of ~~eighteen~~ *eighteen* years, that she has no husband living

Date	No.	Parties Names	Securities Name	Witness Name & Proof &c.	Marriage Return &c.
1811 January the 17 <sup>th</sup> day #14	No 72	John Piper To Margaret Means	John Means Sr.	Both Parties over the age of 21 years & their Personal Consent of John Means the Father of Margaret and Security given by me and G. Robb. etc.	Married on the 3 <sup>rd</sup> day of January 1811 by John Longley. Certificate filed
1811 January the 22 <sup>nd</sup> day	No 73	William Campbell To Mary Tully	John Campbell	Personal Consent of the Father of both the Parties given in presence, they not being of lawful age etc. G. Robb. etc.	Married the 24 <sup>th</sup> day 1811. There is a solemnization of matrimony between William Campbell & Mary Tully by George Johnson.
1811 February the 2 <sup>nd</sup> day	No 74	William Hamilton To Mary Smith	James Smith	Personal Consent of the Father of both Parties given in presence, etc. G. Robb. etc.	Married the 31 <sup>st</sup> day 1811. There was solemnization of matrimony between William Hamilton and Mary Smith by George Johnson.
1811 February the 17 <sup>th</sup> day	No 75	Benjamin Wilson To Cecilia Hall	Joseph Hains	Certificate of Consent from Thomas and Mary Hall Parents of Cecilia filed and duly proved by Joseph Hains. and Certificate for the age of Wilson filed. G. Robb. etc.	Married on the 20 <sup>th</sup> day of February 1811 by John Longley. Certificate filed
1811 March the 13 <sup>th</sup> day	No 76	John Nash To Milley Peters	Samuel Cox	John Nash over the age of 21 years. The Certificate of Consent from Samuel Cox duly proved by Samuel Cox &c. before me G. Robb. etc.	Married the 14 <sup>th</sup> day of March 1811 by Thomas McClinton.

Page No. 1

SCHEDULE 3.—Persons who Died during the Year ending 1st June, 1860, in the County of Hillsdale State of Michigan, enumerated by me, H. H. Smith Ass't Marshal.

1	RESIDENCE					7	8	9	10	11
	2	3	4	5	6					
1	James D. Hawkins	52	18			New York	Nov	Farmer	Cutworm	2 weeks
2	Coastus Stafford	4	12			Mich	March		Pain in throat	12 days
3	Wm. H. Stafford	2	10			do	Nov		do do	do do
4	Lucius Brown	72	15			do	Jan		Inflammation of Lungs	7 do
5	Charlotte Reed	35	2			do	May		Chick pox	1 do
6	Diana Carter	43	18			do	Sept	Farmer	Erysipelas	25 do
7	Sarah A. Watson	2	2			Mich	April		Scarlet fever	14 do
8	Reside C. Watson	1	5			do	do		do do	12 do
9	Levi Sutton	52	18			do	Jan	dry laborer	Inflammation Lungs	13 do
10	Esther Perkins	33	12			do	Sept	Farmer	Inflammation Lungs	do do
11	Friedrich Ehlers	76	18			do	May	Farmer	Old Age	do do
12	Oscar Matson	1	4			Mich			Pain in throat	2 do
13	John P. Bishop	71	12			do	Feb	Farmer	Lung disease	1 year
14	Wm. J. Pierce	2	2			Mich	Oct		Exanthema	14 days
15	Richard Medick	47	10			do	Oct	Farmer	Erysipelas	2 do
16	Thaddeus Wright	78	12			do	May	Farmer	Old Age	do do
17	Agnes Wright	71	2			do	Nov		do do	do do
18										
19										
20										
21										
22										
23										
24										
25										
26										
27										
28										
29										
30										
31										
32										
33										
34										
35										

Total number of deaths: 17

No. of white males: 15  
No. of black males: 2

No. of white females: 12  
No. of black females: 5

Total white deaths: 15  
Total black deaths: 2

No. of returned: 0

REMARKS:

8-1-90

FT/M 0344 049

# GENERAL INDEX TO MARRIAGES—LEWIS COUNTY, KY.—MALES

For name of wife or maiden name refer to Keyhole in front of this section.

Groom's Name	M A L E		Date	Age	Wife's Name	Date	Age
	Wife's Name	Wife's Name					
<u>Bisson</u>	Levi W.				Moore, Mary E.		
<u>Bisson</u>	Levi W.				Moore, Eleanor		
<u>Bisson</u>	George				Shepherd, Jalia A.		
<u>Burkhardt</u>		William			Hughes, Elizabeth		
<u>Bisson</u>		Robert J.			Weatherill, Elizabeth		
<u>Sullivan</u>	John				Barker, Malinda A.		
<u>Sullivan</u>	Alram				Barker, Brunettes		
<u>Burke</u>	Joshua				Edwards, Mary E.		
<u>Burke</u>		Wm.			Thompson, Joan		
<u>Burke</u>	Henry E.				Miles, Mary E.		
<u>Burke</u>	Ernest E.				Hollitt, Malinda		
<u>Burke</u>	J. F.				Happ, E. P.		
<u>Burke</u>	Jas. D.				Happ, Belle		
<u>Burke</u>	Wm. E. A.				Hurdus, Rosa Bell		
<u>Burke</u>		William L.			Besch, Gertrude G.		
<u>Burke</u>		John D.			Gilcerson, Rosa E.		
<u>Burke</u>		Wm. E.			McClasse, Florence		
<u>Burke</u>					Denver, Bertha		
<u>Burke</u>					Gundell, Virgie		
<u>Burke</u>	George, Edgar				Riffe, Milla Belle		
<u>Burke</u>		Boy			Wants, Bellie		
<u>Burke</u>		William E.			Hall, Tillie		
<u>Burke</u>	H. F.				Seal, Pauline		
<u>Burke</u>	Charles				Lawsen, Anna		
<u>Burke</u>	Jesse				Sparks, Margaret		
<u>Burke</u>	David				Hampton, Mrs. Edna		
<u>Burke</u>	Leslie				Hughes, Lorene		
<u>Burke</u>	Andy				Blinders, Gertrude		
<u>Burke</u>	John				Cattrell, Ella		
<u>Burke</u>		Richard			Grant, Sarah E.		
<u>Burke</u>		Walter L.			Milbuff, Ruth		
<u>Burke</u>	Levi B.				Fisher, Martha E.		

A: 76  
A: 105  
B: 86

254  
J: 40

30-172

	Joe Devan	See paid
1829. No 622 overlooked to 16 <sup>th</sup>	Joseph Watkins To Nancy Syffe	Daniel H. Putman See paid
1829. No 623 overlooked to 16 <sup>th</sup>	Raphael W. Thompson To Lucinda N. Cummings	Jonathan Ruggels See paid
1830	Marriage License	Issued in the
1830 No 624 January 23 <sup>rd</sup>	Levi W. Sutton To Mary Moore	Joel Stratton See paid
1830 No 625 January 26 <sup>th</sup>	William Marshall To Fanny Bagby	Alexander Thompson See paid
1830 No 626 January 26 <sup>th</sup>	Jonathan Smally To Wmry Scott	Jacob Scott See paid
1830 No 627 February 26 <sup>th</sup>	James Sweaminger To Elizabeth Montgomery	Thomas Mitchell

give the date to H. Taylor, &c.  
 This certifies that Joseph Watkins &  
 Nancy Syffe were joined together in  
 marriage by me a minister duly authorized  
 on the 25<sup>th</sup> November last  
 at 16. Joseph Robb, Clerk  
 By, Harrison Taylor, D.D.  
 April 17<sup>th</sup> 1830. Daniel H. Putman.

Both parties are over the  
 age of 21 years, and  
 heretofore married.  
 at Jos Robb, Clerk

year 1830. Lewis County, Kentucky

Both the Parties are over  
 the age of 21 years and  
 a certificate filed  
 at Jos Robb, Clerk.

Lewis County, Feb. 11<sup>th</sup> Henry H. Hubert Teacher by  
 Certify that I did on the 7<sup>th</sup> day of January 1830  
 solemnize the Rites of matrimony between  
 Levi Sutton and Mary Moore according  
 to Law given under my hand as one of the  
 Justices of the Peace for said County & directed  
 to celebrate the Rites of matrimony  
 Henry H. Hubert

This will Certify that on the night  
 of the 7<sup>th</sup> January 1830 I solemnized  
 the Rites of matrimony between William  
 Marshall and Fanny Bagby of Lewis  
 County Kentucky, W. P. Mack Knight,  
 Preacher, Methodist, E. Church

Jonathan Smally, is over the  
 age of 21 years as proved by  
 his own oath, and Fanny  
 Scott, over the age of 21 years  
 as proved by a certificate filed  
 at Jos. Robb, Clerk  
 Feb. 12<sup>th</sup> 1830.

James Sweaminger is over  
 the age of 21 years, and  
 Personal Claimant of Thomas  
 Mitchell Guardian for  
 Elizabeth Montgomery given

Recd 8-17-90  
From Lewis Co. Clerk



Miss Spaw  
Spaw

and the complainant upon the proof of the same  
and it is ordered that an affidavit be sworn & filed against  
the defendant all any due bills & returnable here to the next term  
and the cause is continued until the next circuit court -  
2-11-91

Hull's County Kentucky Circuit Court Order Book  
page 262 - March Court Term - 2nd day

Levi Sutton . . . . . Complainant.  
against . . . . . His Chancery upon Injunction -  
William Wade & Mary Annlin Administrators of William Annlin decd. vs  
The Complainant by his Counsel of Law & his Bill in this  
Cause was the 21<sup>st</sup> day of October 1839  
and it appearing to the satisfaction of the Court that the  
defendant the Mary Annlin Administrators of William Annlin  
deceased is not an inhabitant of this Commonwealth and  
she having failed to enter her appearance herein and answer the  
Complaint, bill - It is ordered that unless the said defendant  
appear and answer the Complainant's Bill on or before the  
first day of the next June Term of this Court - That the Court will  
then make a Travers to be entered for her agreeable to the  
act of assembly, and a trial had according to law.  
and the cause is continued until the next term of this  
Court -

Lemuel G. Berris . . . . . Complainant  
against . . . . . His Chancery  
The Heirs of John Caldwell Fizzell, as executors of said decd.  
Ordered that this cause be continued until the next term -

Lewis County Kentucky Circuit Court Order Bk 6 pg 338  
June Court 1840 (3rd day)

and the same is continued until the next Term of this Court. J-11-91

Levi Sullow. . . . Complainant  
against  
William Wade & others. Defendants.

Thursday came the Complainant by his counsel and Plaintiff  
him, Administrator of William Hamilton. . . . having filed to  
enter her appearance. her in and answer the Complainant's bill  
as required by the order of naming made against her in this cause  
at the last Term. It is in the motion of the Complainant now  
Ordered that the Clerk of this Court enter a decree for the said  
William Hamilton the absolute defendant. and thereupon the Clerk in  
pursuance of said Order and by virtue of the act of aforesaid in  
such case made and provided Clerk of the Court. And thereupon for  
the said Plaintiff against the allegations of the bill. and admits  
for her all the facts therein alleged that are for the benefit and  
to the advantage of the said absolute defendant. and denies all  
the allegations of the bill, that are prejudicial to the interest  
of the said defendant. And puts the Complainant upon  
the proof of the same.

And the case is continued until the next Term  
of this Court.

John R. . . . of say St. . . .

Levi Sutton . . . Complainant  
against  
Substancey -

William Wade & Mary Hamlin Defendants -

This day came the Complainant by his Counsel, and the Court rendered the following Decree in this Cause  
Docket - 66

This day this Cause having come to be heard upon Bill in habeas corpus in the Cause ~~and appearing~~ to the Court that Process of Subpoena has been duly served upon the Def. Wm Wade, who has failed to enter his appearance in due time & manner as by law & the Rules of this Court he is bound to do. It is now therefore Ordered & Decreed by the Court that the allegations in the Complainant's Bill & Complaint contained therein are hereby taken for confessed against the said Defendant Wade & it also appearing to the Court that an Order of Training has been duly made & the general Traverse filed as to the Defendant Mary Hamlin (who is a non-resident) by consent of the Court, being satisfied from the ~~proff~~ in the Cause of the equity of the Complainant. It is now (therefore) further Ordered & Decreed by the Court that the Injunction obtained in this Cause by the Complainant Sutton against the Defendants & that the same is hereby made perpetual, & the said Def. Wade hereby forever enjoined from proceeding further at Law against the Complainant upon the Judgment set aside exhibited in the proceedings in this Cause. It is further Ordered & Decreed that the Complainant recover of the Defendants his costs & expenses in this behalf to be taxed that he have execution thereon and the parties are hence dismissed without day.

Lewis County, Ky September Court 1840  
Circuit Court Order Bk 1 Sept  
C. pg 368

William Smith Counsel for Complainant

Levi Sutton . . . Complainant  
against  
William Wade & Mary Hamilton Defendants -  
In Chancery -

This day came the Complainant by his Counsel, and  
the Court rendered the following Decree in this Cause  
To wit -

This day this Cause came on to be heard  
upon Bill in Chancery & petitions in the Cause & it appearing to the Court that Process of  
Subpoena has been duly served upon the Def<sup>t</sup>. W<sup>m</sup> Wade, who has failed to enter his appearance  
in due time & manner as by law & the Rules of this Court, he is bound to do. It is now therefore  
Ordered & Decreed by the Court that the allegations in the Complainants Bill  
& Petition contained therein are hereby taken for confessed against the said Defenda  
Wade & it also appearing to the Court that an Order of Marriage has been duly made  
& the general Excuser filed as to the Defendant Mary Hamilton is a non-voidable  
order of the Court being satisfied from the Proff in the Cause of the equity of the  
Complainant. It is now therefore further Ordered & Decreed by the Court that the  
Injunction obtained in this Cause by the Complainant Sutton against the Defendants  
Wade and the same is hereby made perpetual. & the said Def<sup>t</sup>. Wade is hereby forever enjoined  
from proceeding further at Law against the Complainant upon the Judgment but the  
exhibited in the petitioning of this Cause. It is further Ordered & Decreed that the  
Complainant recover of the Defendants his costs & expenses in this behalf to be taxed  
that he have execution thereon & that the parties are hence dismissed without day.

Duplicate Pp 28

William Smith Complainant

184

81-90

Film 0851647 NSDAR Kentucky Marriage Records  
Lewis Co. 1806-51

KENTUCKY VITAL STATISTICS

RECORD OF MARRIAGES IN LEWIS COUNTY KENTUCKY  
FOR THE PERIOD OF YEARS 1806 TO 1851 INCLUSIVE.

COUNTY SEAT OF LEWIS COUNTY  
VANCEBURG, KENTUCKY.

COMPILED BY  
ANNIE WALKER BURNS  
FRANKFORT, KENTUCKY  
BOX 45.

22506

April 1932.

# 23-8

RECORD OF MARRIAGES IN LEWIS COUNTY KENTUCKY  
FOR THE PERIOD OF YEARS 1806 TO 1851 INCLUSIVE.

GROOM & PARENT	BRIDE & PARENT	DATE
Stratton, Aaron Elmore	Mitchell, Thos f Mabony, Lucretia	1-8-1845
Stratton, Joel	Irvin, Betsy	1-8-1827
Stratton, Joel	Montgomery, Julian f John	9-9-1820
Stratton, Thompson, H	Priest, Lucy B f Daniel	8-14-1820
Stratton, Thompson H	Owens, Sarah	1-8-1833
Stratton, Albert, G	Hams, Lorena f John	1-8-1847
Stratton, Thomas, J	Copens, Virginia gdn Orcutt, Augustus	1-8-1851
Stricklett, Peter	Ginn, Betsy Ann f William	1-8-1831
Stricklett, Jacob Jr.	Griffith, Frances m Betsy b Hemskiah	1-8-1826
Stricklett, George W.	Smith, Amanda f Alexander	1-8-1848
Sullivan, John	Parker, Madeline A f Ambrose	1-8-1851
Strode, Sylvester, B	Pollard, Mary H f John	1-8-1842
Sutherland, William	Hughes, Elizabeth f Jesse	1-8-1844
Sutton, Robert L f Eleanor	Featherkile, Elizabeth	1-8-1850
Sutton, Levi W	Moore, Eleanor f Joseph <i>Moore</i>	1-8-1831
Sutton, Levi W	Moore, Mary b Stratton, Joel	1-8-1830
Sutton, George	Shepherd, Julia Ann b Benjamin	1-8-1840
Swartzala, George	Cox, Eleanor f Samuel	1-8-1823
Swearing, James	Montgomery, Elizabeth gdn Mitchel, Thos	1-8-1830
Swearingen, Bradford, I J	Griffith, Eester Ann gdn Havens, Wm J	1-8-1851
Swearingen, William	Prentice, Almira, b Swearingen, James	1-8-1833
Swearingen, Eli	Silvey, Margaret f James b Moses	1-8-1826
Swearingen, David P	Gibbens, Margaret,	1-8-1828
Swearingen, John Jr.	Gilgeese, Zilphey f George	1-8-1824
Swearingen, Charles	Richards, Catharine m Jane	10-16-1819
Swingle, George	Savagt, Mary b Lawson Bane	1-2-1812

- Eleanor Sutton, mother of 26 year molder

*Wrong dates*

PRESS # No 0048

*Saban*  
*No connection*  
*Observed because no given name in indep. Could have been George Warren*

Recd 3-10-93

## CERTIFICATE OF DEATH

State Office No.

1-96

PLACE OF DEATH

County Branch

MICHIGAN DEPARTMENT OF PUBLIC HEALTH

Office of the State Registrar  
and Center for Health StatisticsRegistered No. 208

Township \_\_\_\_\_

Village \_\_\_\_\_

City Union (No. \_\_\_\_\_ St. \_\_\_\_\_ Ward \_\_\_\_\_)Not Named

(If death occurred in a hospital or institution, give its NAME instead of street and number.)

FULL NAME \_\_\_\_\_

SEX	<u>Male</u>	COLOR OR RACE	<u>White</u>	MARITAL STATUS	<u>Single</u>	AGE: YEARS MONTHS DAYS	BIRTHPLACE	<u>Michigan</u>
OCCUPATION OF DECEASED	<u>None</u>					DATE OF DEATH	<u>April 4,</u>	<u>1875</u>
NAME OF FATHER	<u>Wilber Warren</u>					CAUSE OF DEATH	<u>Stillborn</u>	<u>18</u>
RESIDENCE OF FATHER	<u>Union</u>							
NAME OF MOTHER	<u>Eva Warren</u>							
RESIDENCE OF MOTHER	<u>Union</u>							
						<u>August 31,</u>	<u>19</u>	<u>Frank Newberry</u>
						Filed _____	<u>18</u>	Registrar

I hereby certify that the above is a true and correct transcript of the record of death on file in the Michigan Department of Public Health.

*George Jan Amberg*  
 State Registrar  
 March 3, 1993

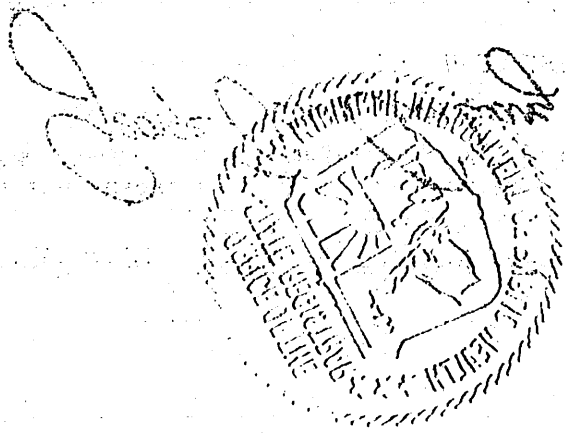

100-100000



## Levi W. Sutton in Lewis Co, Ky.

Joseph Moore, prob. father of Levi Sutton's wives, first appears on tax roll in 1808. He may have appeared in 1807, the first year of record, but <sup>the</sup> Moore page is illegible. He continues to appear through 1859, the last year in records I obtained. This Joseph Moore never owned any property. He was sometimes referred to as Joseph Moore, Senr.

Another Joseph Moore appeared in 1827, owning 100 acres. Over the years he increased his holdings to 202 acres and his estate increased in value substantially. He may be the son of the above Joseph Moore and the brother of Levi Sutton's wives.

A third Joseph Moore appears in the tax lists in 1857 and is called "Junior" in 1858. He is probably the son of the second Joseph Moore above.

Levi W. Sutton & Mary Moore <sup>obtained a marriage license</sup> on 2 Jan. 1830. Both parties were over the age of 21. Joel Stratton appeared as Security. They were married 4 Jan 1830 by Henry Holbeck, J. P.

On 4 Sept 1830, Levi bought Lot No. 42 in the Town of Concord, Lewis Co, Ky. for \$30 from the Town of Concord.

Levi Sutton first appears on the Lewis Co. Tax Roll in 1830. The lists were prepared in June and apparently listed only persons over 21 years of age. This appearance in 1830 may imply that he came to Lewis Co. between June 1829 and June 1830, or it might be that he was omitted in 1828 & 29.

From his age (52) at death in Jan 1860, he was probably 21 sometime in 1829.

Levi W. Sutton and Eleanor Moore obtained a marriage license on 16 Sept 1831. He was over 21, but Eleanor was not. Her father, Joseph Moore, gave "personal consent." Joseph Moore appeared as Security. They were married 18 July 1831 by William F. Morisy "according to the Rites of the Sect to which I belong." There is no clue as to which sect.

From the above, it may be inferred that Levi's first wife died within the first 20 months of their marriage, possibly in childbirth, and that Levi married her younger sister.

Levi Sutton sold his lot in Concord to William Wade on 10 May 1831. The amount is illegible. He appears on the 1831 Tax Roll without property and owning one horse worth \$4. The sale may have been related to

the death of his first wife.

Levi appears in the following tax lists - (no 1832), 1833-1844. He does not appear thereafter. During this entire period, he had no estate other than a horse, and later a cow or two. When they started listing school-age children in 1840, Levi had 2 aged 7-12. In 1841, none listed. In 1843, 4 aged 5-16. In 1844, 3 aged 5-16.

Apparently Levi divorced or abandoned Eleanor between June 1844 and June 1845, which is consistent with his marriage to Catherine Warren on 30 Jun 1847 in Cuyahoga Co., OH.

He bought land in 1841 and ~~A George Sutton, relationship unknown, showed up on the 1841 Tax Roll with~~ had 35 acres in the Cabin Creek watershed with a value of \$320.

On 12 October 1840, <sup>A</sup>George Sutton, relationship unknown, obtained a marriage license with Julia Ann Shepherd, and they were married on the thirteenth. <sup>the deed of sale for his land was recorded in 1851.</sup> He remained on the tax list until 1845.

There may be no connection between him and Levi, and he could be one of the Suttons that appeared in Michigan after 1850.

Ellen (Eleanor) Sutton showed up on the 1848 tax list with no males over 21 and 3 children between 5 and 16. She still had 1 horse and 2 cows, and the estate was worth \$20. She is absent from the tax lists for 1849-52.

On 7 May 1850, Robert J. (?) Sutton and Elizabeth Fenton Kite obtained a marriage license. Eleanor Sutton, mother of Robert, gave her consent. Elizabeth was over 21. David Hildebrand appeared as security. There was no return of the marriage being performed.

In 1851, Jackson Sutton and Robert Sutton appear on the tax list with no property; Ellen is absent.

In 1852, only Jackson Sutton appears; in 1853, Nelly Sutton with 3 children 6 to 18 and Robert Sutton; in 1854 Jackson Sutton, Robert Sutton, and Nelly Sutton with 4 children 6-18; in 1855 only Robert Sutton; in 1856, Robert Sutton and Nelly Sutton with 2 children 6-18; in 1857, Robert Sutton and Nelly Sutton with 1 child 6-18; in 1858, only Robert Sutton; in 1859, Robert Sutton with 2 children 6-18 and one blind person (Nelly?).

# GENERAL INDEX TO MARRIAGES—DEWIS

(For the name for reference to Keytable in front of this section.)

M A L E		M A R R I E D	
GIVEN NAMES A B C D E F G H	GIVEN NAMES I J K L M N O	GIVEN NAMES P Q R S T U V W X Y Z	DATE
Sutton	Levi W.	Moore, Mary	
Sutton	Levi W.	Moore, Robert	
Sutton		Moore, John A.	
Sutherland	William	Moore, John A.	
Sutton	Robert J.	Hughes, Elizabeth	
Sullivan	John	Leatherick, Elizabeth	
Sullivan	Abram	Tarker, William A.	
Sutton	Joshua	Tarker, Elizabeth	
	Edwards, Marie Aug 5, 1872	Edwards, Mary E.	
	John	Thompson, John	
	Henry P.	Kiles, Mary E.	
	FRISK C.	Kollitt, Hannah	
	J. Y.	Kapp, E. F.	
	Jas. D.	Kapp, Belle	
	George A.	Burdus, Ross Hall	
	William L.	Beach, Gertrude G.	
	John D.	Gilderson, Rosa E.	
	Wm. K.	McCleese, Florence	
	Esther	Conver, Bertha	
	Ernest	Candell, Virginia	
Sullivan	George, Edgar	Riffe, Ella Belle	
Sutton	Counts, Sallie Aug 14, 1909	Counts, Sallie	
Sullivan	H. F.	Hall, Filled	
Sullivan	Charles	Neal, Pauline	
Supter	Jesse	Rawson, Anna	
Sutton	David C.	Sparks, Margaret	
Sullivan	Leslie	Hampton, Mrs. Dill Sep 7, 1917	
Sullivan	Andy	Hughes, Lorena	
Sutton	John	Hinders, Cora	
Sullivan	Richard	Cattrell, Ella	
Sullens	Walter L.	Grant, Susan	
Sullivan	Daniel B.	Hampton, Mrs. Dill Aug 28, 1917 Cattrell, Ella	

# GENERAL INDEX TO MARRIAGES—LEWIS COUNTY, KY.—MALES

Locate name by reference to Keytable in front of this section.

SURNAME	M A L E			F E M A L E	DATE			AGE
	GIVEN NAMES A B C D E F G H	GIVEN NAMES I J K L M N O	GIVEN NAMES P Q R S T U V W X Y Z		MONTH	DAY	YEAR	
Sunefrank	Cliff Jr.			Whitman, Imogene	June	26	1937	31
Sullivan	Charles Henry			Knapp, Lydia	Nov.	11	1939	32
Sutton		Martin		Copas, Daisy	April	26	1941	33
Sullivan			Raymond	Bennett, Velma	July	17	1948	35
Sullivan			Virgil	Hughes, Ethel	Feb.	9	1953	36
Sullivan			Russell	Miller, Dorothy Jean	May	11	1955	37
Suter,	Donald Eugene			Pratt, Judith Page	Feb.	5	1955	37
Sullivan			William J.	Hampton, Edith June	May	31	1955	37

3:419

FHL Film 0344050 32393  
**GENERAL INDEX TO MARRIAGES—LEWIS COUNTY, KY.—FEMALES**

Locate name by reference to Keytable in front of this section.

1466

**F E M A L E**

**M A L E**

**DATE**

**REGISTRATION**

**SURNAME**

**GIVEN NAMES  
A B C D E F G H**

**GIVEN NAMES  
I J K L M N O**

**GIVEN NAMES  
P Q R S T U V W X Y Z**

**Month Day Year**

SURNAME	GIVEN NAMES A B C D E F G H	GIVEN NAMES I J K L M N O	GIVEN NAMES P Q R S T U V W X Y Z
Sully		Nancy	
Suman			Sophia
Sultin	Ann		
Sues		Mary Ann	
Sullivan	George Ann		
Sutton	Ellen		
Summers	Anna		
Sutton	Catherin		
Sullivan	Florence P.		
Sullivan		Mollie E.	
Sullivan	Ella		
Sump	Anna		
Sullivan		Ocie B.	
Sulack		May	
Sullivan	Emma K.		
Sullivan		Mable C.	
Sullivan			Sophia
Sullivan			Vina B.
Sullivan		Lizzie	
Sumpter	Ella		
Sullivan		Jessie	
Sullivan	Hattie Irene		
Sullivan			Tressie
Sullivan	Beryl		
Gulzer			Sarah
Sullivan		Mary W.	
Sullivan	Ella		
"	Florence		
"		Orna M.	
"	Helen		
"	Dorothy Jewell		
"		Mary	

M A L E	DATE	REGISTRATION
	Month Day Year	Month Day Year
Radman, Samuel	Sept 23 1888	A 200
Carpenter, Charles L.	Jan 24 1888	B 20
Virgins, Brice	Oct 4 1888	B 200
Zornes, Phillip F.	July 20 1888	B 20
Lantz, Henry T.	Apr 6 1879	T 200
Cogan, Samuel	AUG 28 1878	T 200
Blankenship, James	L 192	Dec 21 1879
Hiltebrand, Abraham	1884	July 9 1884
Wells, Asa	N 453 →	Jan 14 1888
Faynter, George B.		Apr. 5 1890
Redden, William H.		Nov. 5 1890
Lesie, Horace L.		Nov. 5 1891
Swearingen, Henry M.		Mar. 27 1892
Dotson, Milton F.		Sept. 21 1897
Himes, Walter C.		Nov. 8 1897
Blaine, Eldridge		Dec. 24 1898
Christy, S. J.		Aug. 20 1900
Segraves, Henry		Nov. 28 1900
Christy, Henry L.		June 4 1903
McCormick, Marion		Dec. 31 1905
Rais, George C.		Apr. 29 1907
Newberry, Thomas H.		Oct. 9 1912
Liles, Edward		Jan. 26 1916
Landreth, David		Jan. 16 1918
Goss, Henry T.		Mar. 27 1918
Meal, Charles Albin		Aug. 16 1919
Logan, John F.		Jan 11 1926
Darlington, W. A.		Aug. 17 1929
McCally, Vess C.		Feb 1 1930
Hill, Clyde		Oct 10 1931
Jarvis, John Mark		July 5 1932
Moon, Vane		June 12 1933

323-85

# GENERAL INDEX TO MARRIAGES—LEWIS COUNTY, MO.

Locate name by reference to Keytable in front of this section.

SURNAME	M A L E			F E M A L E	DATE	PLACE
	GIVEN NAMES A B C D E F G H	GIVEN NAMES I J K L M N O	GIVEN NAMES P Q R S T U V W X Y Z			
Bayless	Andrew J.			Reid, Isabelle	Nov.	
Bayless	John Henry			Polle, Nancy	Aug.	
Bayless	Nathan			Moore, Elizabeth Jane	Jan.	
Bayless	Daniel			Lantz, Eliza	Dec.	
Bayless	John			Redman, Louisa J.	Jan.	
Bayless	Henry J.			Penrod, Mary J.	May	
Bayless	Henry J.			Jones, Eva	Dec.	
Bayless	James			Grant, Elias J.	June 18	
Bayless	Daniel			Montgomery, Effie L.	June 6	
Bayless	Benjamin			Lewis, Rosa B.	Sept. 21	1890
Bayless	Fredrick A.			Craig, Bertha L.	April 22	1890
Bayless	Simon N.			Kilgore, Hannahette	Jan. 25	1890
Bayless	John			Alexander, Catherine M.	May 26	1890
Bayless	Samuel L.			Walker, Maggie	Jan. 1	1890
Bayless	Benjamin			Penrod, Luama	Feb. 28	1890
Bayless	Benjamin			Kilgore, Lillie Ann	April 24	1890
Bayless	Milton			Taylor, Daisy	April 16	1890
Bayless	Dewey			Graham, Effie	Feb. 15	1890
Bayless	Clyde D.			Young, Dorothy D.	Dec. 5	1890
Bayless	Russell			Bennett, Madeline Esthleen	Feb. 19	1890
Bayless	Henry			Moore, Pearl	Mar. 17	1890
Bayless		Milburn		Plannery, Pauline	Jan. 3	1890
Bayless.	Bruce.			Johnson, Pearl.	Jan 27	1890
Bayless,		J. H.		Wills, Bessie	Oct. 17	1890
Bayless,	Arthur			Huggins, Laura Belle	July 20	1890
Bayless	Bruce			Kilgore, Mary A.	Dec. 5	1890

File 059/049

FNL FILM 0855031-6 LEWIS COUNTY WILLS

3-23/93

with his line to his corner, thence down the stream to the main branch; thence up said branch (to a stone) far enough to include fifty acres by running straight across the field in an easterly direction to where there has been a fence moved of opposite thereto stone; thence with the direction of said fence now to the beginning.

16th. I will and hereby appoint my son, William J. Tully my executor of this, my last will and testament. In witness and testimony whereof I have hereunto set my hand and seal this 22nd day of March 1863.

William Tully.

*Father of John N. Bayless*

Henry Bayless.

I, Henry L. Bayless of the County of Lewis and state of Kentucky being of sound mind and memory but weak in body and knowing the uncertainty of life do hereby make and ordain this as my last will and testament hereby revoking and making void all former wills by me at any time made. Item. 1st. My will is after my decease my body be decently buried in a manner corresponding with my estate and situation in life. Item two. I will that so soon after my decease as may be that my just debts and funeral expenses be paid out of the first money arising from my estate. Item 3. I will and bequeath to my beloved wife Catherine Bayless all my estate real and personal that may remain after the payment of my just debts and funeral expenses to have and to hold to her own proper use and benefit so long as she shall live. Item 4. After the death of my beloved wife Catherine I give and bequeath to my son John H. Bayless and to the heirs of Nathan Bayless is to have the one fifth part and to carry out the provisions

of my will I hereby constitute and appoint my beloved wife Catherine Bayless and my son Nathan Bayless Executors of my last will and testament. In testament hereof, I, Henry L. Bayless, Testator have hereunto set my hand and affixed my seal this 24th day of August A. D. 1860

Henry Bayless.

Nancy Ann Willett's Will.

I, Nancy Willett of the county of Lewis and state of Kentucky being of sound mind and memory, but deeply sensible of the uncertainty of human life, do make, ordain, publish and declare this to be my last will and testament, that is to say.

Item, first, I give to my daughter Martha Wallingford the sum of one thousand dollars in money. Item second. I give to my daughter ~~Priscilla Hart~~, the sum of six hundred dollars in money which my executrix hereinafter named, is directed to pay over to her as early after my decease as may be convenient. Item 3. I give to my grand son William H. Richardson, the sum of three hundred dollars of money. Item fourth. I give to my grand daughter Elizabeth Casper(?) the sum of four hundred dollars in money. Item fifth. I give to my grand daughter, Martha Young, the sum of four hundred dollars in money. Item sixth. I give to my grand children Mary Alice Wallingford, Martha E. Wallingford, Sarah E. Wallingford each one hundred dollars in, if they should live to the proper age to receive it, if they or either of them should die, then their portion to be paid to their two oldest sisters equally. Item seventh. After the payment of my just debts



Lewis Co. Historical Socy.

Box 211

Vanceburg, KY 41179

Member # 334

Barbara Featherkile

2605 Chesterfield Ct. #1 Membership 500

Cincinnati, Ohio 45239

Paris FEATHERKILE

b. 7 May 1885  
m. 20 Aug 1919  
d. 26 Jan 1929

Sylvester FEATHERKILE

b. 27 Oct 1858  
m.  
d. 6 Jul 1940

David FEATHERKILE

b. 1820  
m. 2 Oct 1850  
d. 11 Mar 1862

Margaret HICKS

b. Aug 1832  
d. circa 1902

Sylvester DETRO

1821  
m. 25 Sep 1851  
d.

Sarah DETRO

b. 6 Apr 1856  
d. 17 Mar 1928

Rebecca HICKS

b. 1834  
d.

John DAULTON

b.  
d.  
b.  
d.

William DAULTON

b. 13 Feb 1866  
m. 12 Dec 1886  
d. 29 Nov 1926

Alberta DAULTON

b. 23 Mar 1900  
d. 8 Jul 1980

Andrew DICKSON

b. 1844  
m. 28 Jun 1865  
d.

Margaret DICKSON

b. Mar 1867  
d. circa 1907

Charlotte FEATHERKILE

b. 3 Oct 1849  
d. 10 Jul 1927

William FEATHERKILE

b. 18 Aug 1920  
m. 23 Sep 1940  
d.

Barbara FEATHERKILE

b. 9 Aug 1950  
m. 24 Feb 1966  
Donald Jennings  
div. 8 Sep 1980

Dolores NADERMANN

b. 25 Mar 1919  
d. 21 Jan 1980

Andrew FEATHERKILE

b.  
d. circa 1831  
Nancy (SECRIST?)  
b. 1794  
d. circa 1854  
John HICKS ?  
b. 1804  
d. 15 Jul 1875  
Mary THOMPSON ?  
b. circa 1800

b.  
d.

b.  
d.  
John HICKS ?

b. 1804  
d. 15 Jul 1875  
Mary THOMPSON ?  
b. circa 1800  
d. 19 Jul 1893

b.  
d.

b.  
d.

b.  
d.

b.  
d.

George DICKSON  
b. 1819  
d.

Catherine FEATHERKILE  
b. 1822  
d.

DAVID FEATHERKILE  
b. 1820  
d. 11 Mar 1862  
Margaret HICKS ?  
b. Aug 1832  
d. circa 1902

(4)

Andrew Featherkile served, in the War of 1812 in Captain's John Davidson's Company. He died circa 1831 in Adams County, Ohio.

Nancy was born in 1794 in Pennsylvania. Her father could have been George Secrist. After Andrew's death Nancy married John Helterbrand 15 Oct 1832 in Adams County and then they moved to Lewis County, Kentucky. Nancy died circa 1854.

Andrew and Nancy were the parents of the following children.

1. Eliza Jane born 1815; married Abrahma Hildebrand 21 Dec 1847.
2. George born 1817; married Sarah Hicks 30 Jun 1847; married Nancy Thoughman 7 Jan 1852.
3. David born 1820; married Margaret Hicks 2 Oct 1850; died 11 Mar 1862.
4. Catherine born 1822; married George Dickson 16 Sep 1840.
5. Mary Ann born 1824; married William Cross 28 Feb 1854.
6. Elizabeth born 1826; married Robert Sutton 7 May 1850.
7. Nancy born 1831; married Joseph Moore 21 Feb 1852.

#### JOHN HICKS and MARY THOMPSON

John Hicks was born 1804 in Tennessee. He died 17 Jul 1875 and is buried in East Fork Cemetery in Lewis County, Kentucky.

Mary Thompson was born circa 1800 and died 19 Jul 1893 and is buried in East Fork Cemetery.

John and Mary were the parents of the following children.

1. Sarah born 1830; married George Featherkile 1847; died before 1850.
2. ?? Margaret born 1832; married David Featherkile 1850; died circa 1902.
3. Rebecca born 1834; married Sylvester Detro 1851.
4. Stephan born 1835; married Sarah Helterbrand 1858.
5. Hannah born 1840; married Perry Williams 1846.
6. Riceann born 1842.
7. Charlotte born 1846.

#### DAVID FEATHERKILE and MARGARET HICKS

David Featherkile was born in 1820 to Andrew featherkile and Nancy (Secrist?) possibly in Adams County, Ohio. David died 11 Mar 1862 while serving in the Union Army during the Civil War. He served in Company K, 16th Regiment, Kentucky Volunteer infantry. His name is among those listed on a monument in the courthouse in Vanceburg, Kentucky honoring those from Lewis County who died during the war.

Margaret Hicks was born in August 1832. Her parents could have been John Hicks and Mary Thompson. Margaret died circa 1902.

According to David's military record he and Margaret were married 2 Oct 1850 and were the parents of the following children:

1. ?? Charlotte born 3 Oct 1849; married Andrew Dickson 28 Jun 1865; died 10 July 1927? \*
2. John born 1852; died before 1870
3. Leroy born 28 Jan 1856; married Sarah Lane Aug 1895.
4. Sylvester born 27 Oct 1858; married Sarah Detro; died 8 Jul 1940.
5. William born 1 Jun 1861.

\* It is possible that Charlotte's parents could have been David's brother, George Featherkile and Margaret's sister, Sarah Hicks.

William Daulton was born in Feb 1866 in Mason County, Kentucky. His father was John Daulton. William died 29 Nov 1926 in Adams County, Ohio and is buried in Larshe, Ohio.

Margaret Dickson was born in Mar 1867 in Lewis County, Kentucky. Her parents were Andrew Dickson and Charlotte Featherkile. Margaret died circa 1907 in Adams County and is buried in Kirker's Cemetery.

William and Margaret were married 12 Dec 1886 in Lewis County, Kentucky and were the parents of the following children:

1. Luther born 1887; died 1899
2. Walter born 1891
3. Bessie born 1892
4. Belle Ann born 1894; died 1912
5. Alberta born 23 Mar 1900; married Paris Featherkile 20 Aug 1919; died 8 Jul 1980
6. Clarence born 1903

GEORGE DICKSON and CATHERINE FEATHERKILE

George Dickson was born 1819 in Kentucky.

Catherine Featherkile was born 1822 in Ohio to Andrew and Nancy Featherkile.

George and Catherine were married 16 Sep 1840 and were the parents of the following children:

1. Andrew born 1844; married Charlotte Featherkile 1865
2. Sarah born 1846
3. Susan born 1848
4. Martha born 1854
5. Caleb born 1857
6. George born 1861
7. Rebecca born 1864

SYLVESTER FEATHERKILE and SARAH DETRO

Sylvester Featherkile was born 27 Oct 1858 to David Featherkile and Margaret Hicks in Lewis County, Kentucky. Sylvester died 6 Jul 1940 in High Bridge, Kentucky and is buried somewhere in Garrard County.

Sarah Detro was born 6 Apr 1856 to Sylvester Detro and Rebecca Hicks in Lewis Co., Ky. Sarah died 17 Mar 1928 in Frankfort, Kentucky and is buried in Frankfoet Cem.

A marriage record has not yet been located, but Sylvester and Rebecca were the parents of the following children:

1. Paris born 7 May 1885 in Lewis Co., Ky.; married Alberta Daulton 20 Aug 1919; died 16 Jan 1929 in Frankfoet, Ky.
2. Charles born in January 1888 in Lewis County, Kentucky; died in April 1929 in Frankfort, Kentucky.
3. Margaret born in February 1891 in Lewis Co., Ky.; married James Leek 10 Sep 1908; died 1974/ in Lawrenceburg, Ind.
4. Amos born in July 1893; married Mary Beard 23 Oct 1911.
5. Charlotte born in October 1895; married George Holland 12 Dec 1910.

Sylvester married again after Sarah's death but nothing is known about this marriage.

William Sherman Featherkile was born 18 Aug 1920 to Paris Featherkile and Alberta Daulton in Adams County, Ohio.

Dolores Margaret Nadermann was born 25 Mar 1919 to Henry Nadermann and Theresia Althoff in Cincinnati, Ohio. Dolores died 21 Jan 1970 in Cincinnati and is buried in St. Mary's Cemetery.

William and Dolores were married 23 Sep 1940 in Newport, Kentucky and were the parents of the following children:

1. William Gerald born 25 Oct 1942; married Lexie Stammer in 1963 having one son, Joseph; married JoAnn Leifrig 1965 having two daughters, Wendy and Pam. William died 17 Aug 1974 in Cincinnati.
2. Beverly Ann born 3 Jun 1947; married Donald Spaulding 1964 having two daughters, Christina and Kimberly.
3. Barbara Jean born 9 Aug 1950; married Donald Jennings 24 Feb 1966 having two sons, Donald and James; div. 8 Sep 1980.
4. Michael Sherman born 5 Jan 1955; married Penny Bader 1978 having two sons, Nicholas and Stephan.

William married Bette Stamper in 1971.

PARIS FEATHERKILE and ALBERTA DAULTON

Paris Clifford Featherkile was born 7 May 1885 to Sylvester Featherkile and Sarah Detro in Lewis County, Kentucky. Paris died 26 Jan 1929 in Frankfort, Kentucky and is buried in Frankfort Cemetery.

Alberta Ruth Daulton was born 23 Mar 1900 to William Daulton and Margaret Dickson in Adams County, Ohio. Alberta died 8 Jul 1980 in Cincinnati and is buried in Spring Grove Cemetery.

Paris and Alberta were married 20 Aug 1919 in Adams County, Ohio and were the parents of the following children:

1. William Sherman born 18 Aug 1920; married Dolores Nadermann 1940.
2. Charles born 1922; died as a small child
3. Kenneth Roland born 1924; died 1985
4. Willanna born Jun 1925; died Aug 1925
5. Clarence Edward born 1927

Alberta married twice more; John Hicks having two sons, John Jr. and Donald; Frank Kelly having no children.

Paris was supposed to have been married before; Nothing is known about this marriage but on his and Alberta's marriage license his residence is listed as Lexington. perhaps a marriage can be located there.

QUERY FROM THE MAILBAG

CHARTERS: To whom it may concern: I work with volunteers at the GLENMARY FARM on Lower Kinney Road, Lewis Co. Ky. Each time I come to this area I drive through the Charters area. My family has been working on our "Family Roots" for many years. I was wondering if there is any information on how the area came to be named, if the place was named for some family that was living there or how the name came about. Noah and Hazel Kinney suggested I write to the Lewis Co. Historical Society to see if you had any information you might share with me. Any help would be appreciated. If any one can help contact: TOM CHARTERS, % Glenmary Home Missioners, P.O. Box 465618, Cincinnati, Oh. 45246-5618

# Family Group Sheet

From Sandra L. Lewis  
July 94

Husband's Full Name

*Joseph Moore Sr.*

Chart No.

Person's Data	Day Month Year	City, Town or Place	County or Province, etc.	State or Country	Add. Info. on Husband
Birth	6-11-1797			Va	
Chr'nd					
Marr.	7-3-1816	Randolph Co		Va	
Death					
Burial					
Places of Residence <i>Randolph Co. Va, Belmont Co. Oh, Lewis Co. Ky, ???</i>					
Occupation _____ Church Affiliation _____ Military Rec. _____					
Other wives, if any, No. 1 to 20 etc. Make separate sheet for each marr.					

His Father

Mother's Maiden Name

Wife's Full Maiden Name

*Mary Ann Cross*

Wife's Data	Day Month Year	City, Town or Place	County or Province, etc.	State or Country	Add. Info. on Wife
Birth	2-2-1797			M.D	
Chr'nd					
Death					
Burial					
Places of Residence _____					
Occupation _____ Church Affiliation _____ Military Rec. _____					
Other husbands, if any, No. 1 to 20 etc. Make separate sheet for each marr.					

Her Father

*John Cross*

Mother's Maiden Name

*Barbara Booher*

Sex	Children's Names & Full (Arrange in order of birth)	Children's Data	Day Month Year	City, Town or Place	County or Province, etc.	State or Country	Add. info. on Children
1	<i>Daniel Moore</i>	Birth	8-11-1818			Va	
	Full Name of Spouse <i>Mary Hickle</i>	Marr.					
		Death	1853			Ky?	
		Burial					
2	<i>John Moore</i>	Birth	3-3-1822			Va	
	Full Name of Spouse	Marr.					
		Death					
		Burial					
3	<i>Rebecca Moore</i>	Birth	15-9-1826			Va	
	Full Name of Spouse <i>Joseph Boston</i>	Marr.	9-3-1845				
		Death	19-6-1897				
		Burial					
4	<i>Samuel Moore</i>	Birth	3-11-1829				
	Full Name of Spouse <i>Edgington</i>	Marr.					
		Death					
		Burial					
5	<i>Joseph Moore</i>	Birth	28-3-1832		Belmont Co. Oh		
	Full Name of Spouse <i>Nancy L. Featherhile</i>	Marr.	21-2-1852		Lewis Co Ky		
		Death					
		Burial					
6	<i>Richard Moore</i>	Birth	28-2-1834		Belmont Co. Oh		
	Full Name of Spouse <i>Mary Hickle Moore</i>	Marr.					
	<i>Sarah Ann Hielout</i>	Death	1916	Green Twp. Adams Co. Oh			
		Burial	(1) 31-1-1854	Lewis Co. Ky	(2) 1880	Adams Co. Oh	
7	<i>Barbara Moore</i>	Birth	1835		Belmont Co. Oh		
	Full Name of Spouse <i>William Houston</i>	Marr.					
		Death	1919				
		Burial					
8	<i>Deborah Moore</i>	Birth	1839		Belmont Co. Oh		
	Full Name of Spouse <i>John Smith</i>	Marr.					
		Death					
		Burial					

Compiler	Notes
Address	
City, State, Zip	
Date	

(other side)

P.O. Box 368, Logansport, IN 48721. Publishers of The Genealogical Helper. Send for a free catalogue with list and full descriptions of many genealogical aids.

Husband's Full Name

Husband's name

Wife's name

Sex	Children's Names in Full (Arrange in order of birth)	Children's Date	Day Month Year	City, Town or Place	County or Province, etc.	State or Country	Add. info. on Children
	9 Phillip Moore	Birth	1842		Belmont Co	Oh	
	Full Name of Spouse	Marr.					
	Elizabeth Adams	Death	1919	Greene Twp	Adams Co.	Oh	
		Burial					
	10	Birth					
		Marr.					
	Full Name of Spouse	Death					
		Burial					
	11	Birth					
		Marr.					
	Full Name of Spouse	Death					
		Burial					
	12	Birth					
		Marr.					
	Full Name of Spouse	Death					
		Burial					
	13	Birth					
		Marr.					
	Full Name of Spouse	Death					
		Burial					
	14	Birth					
		Marr.					
	Full Name of Spouse	Death					
		Burial					
	15	Birth					
		Marr.					
	Full Name of Spouse	Death					
		Burial					

Sources for Husband:

Sources for Wife:

Sources for Children:

Additional Information:

# Family Group Sheet

Husband's Full Name

*Joseph Moore Jr.*

Chart No.

<small>Husband's Data</small>	Day	Month	Year	City, Town or Place	County or Province, etc.	State or Country	Add. Info. on Husband
Birth							
Chr'd							
Marr.				<i>19 June 1852 Lewis Co - Ky.</i>			
Death							
Burial							

Places of Residence		
Occupation	Church Affiliation	Military Rec.

Other wives, if any, No. 19 (2) etc. Make separate sheet for each marr.

His Father *Joseph Moore Sr.* Mother's Maiden Name *Mary Ann Cross*

Wife's Full Maiden Name

*Nancy Featherkila*

<small>Wife's Data</small>	Day	Month	Year	City, Town or Place	County or Province, etc.	State or Country	Add. Info. on Wife
Birth							
Chr'd							
Death							
Burial							

Places of Residence		
Occupation	Church Affiliation	Military Rec.

Other husbands, if any, No. 19 (2) etc. Make separate sheet for each marr.

Her Father *Walter Brand* Mother's Maiden Name

Sex	Children's Names in Full (Arrange in order of birth)	Children's Data	Day	Month	Year	City, Town or Place	County or Province, etc.	State or Country	Add. info. on Children
	<i>1 George</i> Full Name of Spouse	Birth							
		Marr.							
		Death							
		Burial							
	<i>2 Richard</i> Full Name of Spouse	Birth							
		Marr.							
		Death							
		Burial							
	<i>3 James</i> Full Name of Spouse	Birth							
		Marr.							
		Death							
		Burial							
	<i>4 John</i> Full Name of Spouse	Birth							
		Marr.							
		Death							
		Burial							
	<i>5 William</i> Full Name of Spouse	Birth							
		Marr.							
		Death							
		Burial							
	<i>6 Thomas</i> Full Name of Spouse	Birth							
		Marr.							
		Death							
		Burial							
	<i>7</i> Full Name of Spouse	Birth							
		Marr.							
		Death							
		Burial							
	<i>8</i> Full Name of Spouse	Birth							
		Marr.							
		Death							
		Burial							

Compiler	Notes:
Address	
City, State, Zip	
Date	

P. O. Box 308, Logan, UT 84321, Publishers of The Genealogical Helper Send for a free catalogue with list and full descriptions of many genealogical aids.

Husband's Full Name





**HUSBAND: Levi W. Sutton** 154  
 Born: circa 1807 Newark, Essex Co, NJ<sup>1</sup>  
 Marr: 30 Jun 1847 Dover Twp, Cuyahoga Co, OH<sup>2</sup> 45  
 Died: Jan 1860 Allen, Hillsdale Co, MI<sup>3</sup>  
 Other w:  
 1830: Mary Moore 1642  
 1831: Eleanor Moore 1643

**WIFE: Catharine Warren** 153  
 Born: 30 Nov 1829 Akron, Portage Co, OH<sup>4</sup>  
 Died: 18 Feb 1910 Liberty Center, Henry Co, OH<sup>4</sup>  
 Buried: 21 Feb 1910 Hudson, Lenawee Co, MI<sup>4</sup>  
 Father: Daniel Warren 151  
 Mother: Mary ----- 152  
 Other h:  
 1861: Eli Banker 1644

**CHILDREN (X = ancestor of preparer)**

1 F	Name: Lydia Ann Sutton Born: circa 1852 Coldwater, Branch Co, MI <sup>5</sup> Marr: 1 Jan 1870 Coldwater, Branch Co, MI <sup>6</sup> To: Ezeriah J. Parmalee	1637 655 1638
2 F	Name: Sarah Jane "Jenny" Sutton Born: Aug 1854 <sup>7</sup> Marr: To: Willard Lockmere Marr: <i>Charles W.</i> To: ----- Fox	1639 656 1640 661 1645
3 F X	Name: Mary Lovisa "May" Sutton Born: 11 Jan 1859 Allen, Hillsdale Co, MI <sup>8</sup> Marr: 28 Oct 1874 Coldwater, Branch Co, MI <sup>9</sup> To: George Warren Marr: circa 1878 To: Clarence James Porter Sr Marr: 4 Mar 1909 Crown Point, Lake Co, IN <sup>10</sup> To: Samuel Linton Died: 8 May 1928 Toledo, Lucas Co, OH <sup>11</sup> Buried: 10 May 1928 Waterloo, DeKalb Co, IN <sup>11</sup>	32 657 1641 9 31 630 1571

**REFERENCES**<sup>1</sup>From age at death.<sup>2</sup>Cuyahoga Co., Ohio marriage records, 4:403.

HUSBAND: Levi W. Sutton  
WIFE: Catharine Warren

**REFERENCES (Continued)**

---

- <sup>3</sup>1860 census mortality schedule, ae 52.
- <sup>4</sup>State of Ohio certificate of death No. 8924.
- <sup>5</sup>Ae 8 1860 census. Place from marriage record.
- <sup>6</sup>Branch Co., MI marriage rec. No. 679.
- <sup>7</sup>1900 census.
- <sup>8</sup>C.J. Porter, Jr. family record.
- <sup>9</sup>Branch Co., MI marriage rec. No. 1964.
- <sup>10</sup>Virginia Owen letter.
- <sup>11</sup>State of Ohio certificate of death No. 31951.